

A : 3房 642'		
樓層	訂價	折實價9%
5	\$13,000,000 @\$20,249	\$11,830,000 @\$18,427
6	\$13,024,000 @\$20,287	\$11,851,840 @\$18,461
7	\$13,048,000 @\$20,324	\$11,873,680 @\$18,495
8	\$13,092,000 @\$20,393	\$11,913,720 @\$18,557
9	\$13,118,000 @\$20,433	\$11,937,380 @\$18,594
10	\$13,165,000 @\$20,506	\$11,980,150 @\$18,661
11	\$13,211,000 @\$20,578	\$12,022,010 @\$18,726
12	\$13,259,000 @\$20,653	\$12,065,690 @\$18,794
15	\$13,306,000 @\$20,726	\$12,108,460 @\$18,861
16	\$13,353,000 @\$20,799	\$12,151,230 @\$18,927

E : 2房 393'		
樓層	訂價	折實價9%
5	\$7,644,000 @\$19,450	\$6,956,040 @\$17,700
6	\$7,659,000 @\$19,489	\$6,969,690 @\$17,735
7	\$7,672,000 @\$19,522	\$6,981,520 @\$17,765
8	\$7,684,000 @\$19,552	\$6,992,440 @\$17,792
9	\$7,700,000 @\$19,593	\$7,007,000 @\$17,830
10	\$7,728,000 @\$19,664	\$7,032,480 @\$17,894
11	\$7,757,000 @\$19,738	\$7,058,870 @\$17,962
12	\$7,784,000 @\$19,807	\$7,083,440 @\$18,024

J : 2房 339'		
樓層	訂價	折實價9%
5	\$7,061,000 @\$20,829	\$6,425,510 @\$18,954
6	\$7,141,000 @\$21,065	\$6,498,310 @\$19,169
7	\$7,169,000 @\$21,147	\$6,523,790 @\$19,244
8	\$7,206,000 @\$21,257	\$6,557,460 @\$19,344
9	\$7,221,000 @\$21,301	\$6,571,110 @\$19,384
10	\$7,248,000 @\$21,381	\$6,595,680 @\$19,456
11	\$7,274,000 @\$21,457	\$6,619,340 @\$19,526
12	\$7,300,000 @\$21,534	\$6,643,000 @\$19,596
15	\$7,328,000 @\$21,617	\$6,668,480 @\$19,671
16	\$7,354,000 @\$21,693	\$6,692,140 @\$19,741
17	\$7,381,000 @\$21,773	\$6,716,710 @\$19,813
18	\$7,411,000 @\$21,861	\$6,744,010 @\$19,894

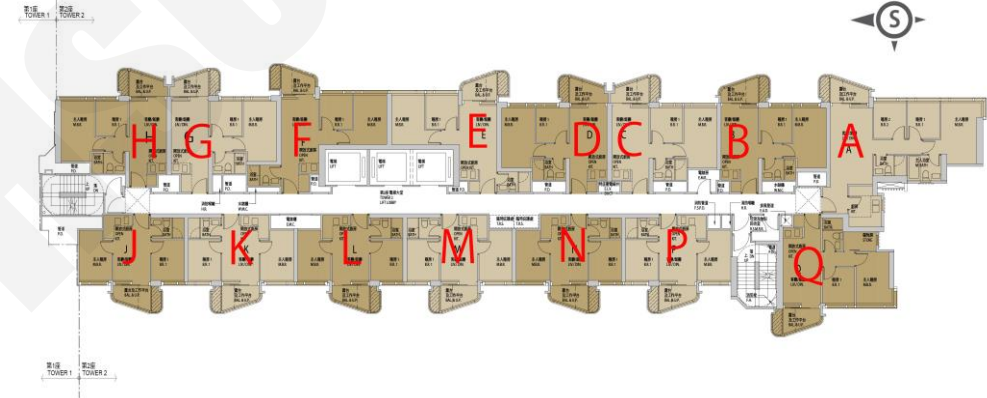

F : 2房 399'		
樓層	訂價	折實價9%
5	\$7,754,000 @\$19,434	\$7,056,140 @\$17,685
6	\$7,769,000 @\$19,471	\$7,069,790 @\$17,719
7	\$7,782,000 @\$19,504	\$7,081,620 @\$17,748
8	\$7,794,000 @\$19,534	\$7,092,540 @\$17,776
9	\$7,810,000 @\$19,574	\$7,107,100 @\$17,812
10	\$7,838,000 @\$19,644	\$7,132,580 @\$17,876
11	\$7,866,000 @\$19,714	\$7,158,060 @\$17,940
12	\$7,894,000 @\$19,784	\$7,183,540 @\$18,004

K : 2房 339'		
樓層	訂價	折實價9%
5	\$7,048,000 @\$20,791	\$6,413,680 @\$18,919
6	\$7,108,000 @\$20,968	\$6,468,280 @\$19,080
7	\$7,135,000 @\$21,047	\$6,492,850 @\$19,153
8	\$7,172,000 @\$21,156	\$6,526,520 @\$19,252
9	\$7,187,000 @\$21,201	\$6,540,170 @\$19,293
10	\$7,214,000 @\$21,280	\$6,564,740 @\$19,365
11	\$7,270,000 @\$21,445	\$6,615,700 @\$19,515
12	\$7,310,000 @\$21,563	\$6,652,100 @\$19,623
15	\$7,337,000 @\$21,643	\$6,676,670 @\$19,695
16	\$7,363,000 @\$21,720	\$6,700,330 @\$19,765
17	\$7,390,000 @\$21,799	\$6,724,900 @\$19,837
18	\$7,419,000 @\$21,885	\$6,751,290 @\$19,915
19	\$7,441,000 @\$21,950	\$6,771,310 @\$19,974

G : 2房 398'		
樓層	訂價	折實價9%
5	\$7,724,000 @\$19,407	\$7,028,840 @\$17,660
6	\$7,776,000 @\$19,538	\$7,076,160 @\$17,779
7	\$7,790,000 @\$19,573	\$7,088,900 @\$17,811
8	\$7,803,000 @\$19,606	\$7,100,730 @\$17,841
9	\$7,818,000 @\$19,643	\$7,114,380 @\$17,875
10	\$7,847,000 @\$19,716	\$7,140,770 @\$17,942
11	\$7,875,000 @\$19,786	\$7,166,250 @\$18,006
12	\$7,903,000 @\$19,857	\$7,191,730 @\$18,070
15	\$7,932,000 @\$19,930	\$7,218,120 @\$18,136
16	\$7,960,000 @\$20,000	\$7,243,600 @\$18,200
17	\$7,988,000 @\$20,070	\$7,269,080 @\$18,264
18	\$8,046,000 @\$20,216	\$7,321,860 @\$18,397
19	\$8,087,000 @\$20,319	\$7,359,170 @\$18,490
20	\$8,115,000 @\$20,389	\$7,384,650 @\$18,554
21	\$8,144,000 @\$20,462	\$7,411,040 @\$18,621

N : 2房 339'		
樓層	訂價	折實價9%
5	\$7,011,000 @\$20,681	\$6,380,010 @\$18,820
6	\$7,066,000 @\$20,844	\$6,430,060 @\$18,968
7	\$7,091,000 @\$20,917	\$6,452,810 @\$19,035
8	\$7,102,000 @\$20,950	\$6,462,820 @\$19,064
9	\$7,142,000 @\$21,068	\$6,499,220 @\$19,172
10	\$7,153,000 @\$21,100	\$6,509,230 @\$19,201
11	\$7,171,000 @\$21,153	\$6,525,610 @\$19,250
12	\$7,183,000 @\$21,189	\$6,536,530 @\$19,282
15	\$7,208,000 @\$21,263	\$6,559,280 @\$19,349
16	\$7,233,000 @\$21,336	\$6,582,030 @\$19,416
17	\$7,259,000 @\$21,413	\$6,605,690 @\$19,486
18	\$7,324,000 @\$21,605	\$6,664,840 @\$19,660

H : 2房 399'		
樓層	訂價	折實價9%
5	\$7,614,000 @\$19,083	\$6,928,740 @\$17,365
6	\$7,665,000 @\$19,211	\$6,975,150 @\$17,482
7	\$7,724,000 @\$19,358	\$7,028,840 @\$17,616
8	\$7,757,000 @\$19,441	\$7,058,870 @\$17,691
9	\$7,781,000 @\$19,501	\$7,080,710 @\$17,746
10	\$7,793,000 @\$19,531	\$7,091,630 @\$17,774
11	\$7,806,000 @\$19,564	\$7,103,460 @\$17,803
12	\$7,828,000 @\$19,619	\$7,123,480 @\$17,853
15	\$7,855,000 @\$19,687	\$7,148,050 @\$17,915
16	\$7,884,000 @\$19,759	\$7,174,440 @\$17,981
17	\$7,911,000 @\$19,827	\$7,199,010 @\$18,043
18	\$7,928,000 @\$19,870	\$7,214,480 @\$18,081
19	\$7,970,000 @\$19,975	\$7,252,700 @\$18,177
20	\$7,997,000 @\$20,043	\$7,277,270 @\$18,239

P : 2房 339'		
樓層	訂價	折實價9%
5	\$7,060,000 @\$20,583	\$6,424,600 @\$18,731
6	\$7,085,000 @\$20,656	\$6,447,350 @\$18,797
7	\$7,110,000 @\$20,729	\$6,470,100 @\$18,863
8	\$7,150,000 @\$20,845	\$6,506,500 @\$18,969
9	\$7,161,000 @\$20,878	\$6,516,510 @\$18,999
10	\$7,172,000 @\$20,910	\$6,526,520 @\$19,028
11	\$7,191,000 @\$20,965	\$6,543,810 @\$19,078
12	\$7,200,000 @\$20,991	\$6,552,000 @\$19,102
15	\$7,226,000 @\$21,067	\$6,575,660 @\$19,171
16	\$7,251,000 @\$21,140	\$6,598,410 @\$19,237
17	\$7,275,000 @\$21,210	\$6,620,250 @\$19,301
18	\$7,341,000 @\$21,402	\$6,680,310 @\$19,476
19	\$7,400,000 @\$21,574	\$6,734,000 @\$19,633
20	\$7,426,000 @\$21,650	\$6,757,660 @\$19,702
21	\$7,486,000 @\$21,825	\$6,812,260 @\$19,861
22	\$7,511,000 @\$21,898	\$6,835,010 @\$19,927
23	\$7,538,000 @\$21,977	\$6,859,580 @\$19,999
25	\$7,563,000 @\$22,050	\$6,882,330 @\$20,065