

# Tower 1

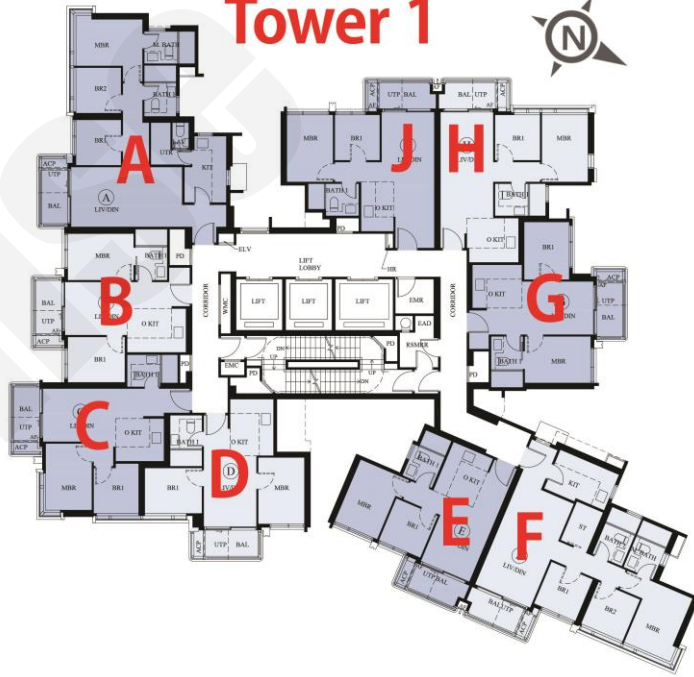

**A : 3房連套房 701'**

樓層	訂價	折實價15%
2	\$9,834,000 @\$14,029	\$8,358,900 @\$11,924
3	\$9,924,000 @\$14,157	\$8,435,400 @\$12,033
5	\$10,014,000 @\$14,285	\$8,511,900 @\$12,143

**B : 2房 416'**

樓層	訂價	折實價15%
2	\$5,799,000 @\$13,940	\$4,929,150 @\$11,849
3	\$5,852,000 @\$14,067	\$4,974,200 @\$11,957
5	\$5,905,000 @\$14,195	\$5,019,250 @\$12,066

**C : 2房 435'**

樓層	訂價	折實價15%
2	\$5,844,000 @\$13,434	\$4,967,400 @\$11,419
3	\$5,896,000 @\$13,554	\$5,011,600 @\$11,521
5	\$5,951,000 @\$13,680	\$5,058,350 @\$11,628
6	\$6,005,000 @\$13,805	\$5,104,250 @\$11,734
7	\$6,041,000 @\$13,887	\$5,134,850 @\$11,804

**E : 2房 424'**

樓層	訂價	折實價15%
2	\$5,952,000 @\$14,038	\$5,059,200 @\$11,932
3	\$6,006,000 @\$14,165	\$5,105,100 @\$12,040
5	\$6,054,000 @\$14,278	\$5,145,900 @\$12,137

**H : 2房 458'**

樓層	訂價	折實價15%
5	\$5,533,000 @\$12,081	\$4,703,050 @\$10,269
6	\$5,584,000 @\$12,192	\$4,746,400 @\$10,363
7	\$5,616,000 @\$12,262	\$4,773,600 @\$10,423
8	\$5,685,000 @\$12,413	\$4,832,250 @\$10,551
9	\$5,685,000 @\$12,413	\$4,832,250 @\$10,551
10	\$5,719,000 @\$12,487	\$4,861,150 @\$10,614
11	\$5,754,000 @\$12,563	\$4,890,900 @\$10,679
12	\$5,782,000 @\$12,624	\$4,914,700 @\$10,731
15	\$5,812,000 @\$12,690	\$4,940,200 @\$10,786
16	\$5,841,000 @\$12,753	\$4,964,850 @\$10,840
18	\$5,893,000 @\$12,867	\$5,009,050 @\$10,937
19	\$5,893,000 @\$12,867	\$5,009,050 @\$10,937
20	\$5,911,000 @\$12,906	\$5,024,350 @\$10,970
21	\$5,929,000 @\$12,945	\$5,039,650 @\$11,004
22	\$5,947,000 @\$12,985	\$5,054,950 @\$11,037
23	\$5,965,000 @\$13,024	\$5,070,250 @\$11,070
25	\$5,982,000 @\$13,061	\$5,084,700 @\$11,102
26	\$6,000,000 @\$13,100	\$5,100,000 @\$11,135
27	\$6,019,000 @\$13,142	\$5,116,150 @\$11,171
28	\$6,054,000 @\$13,218	\$5,145,900 @\$11,236
29	\$6,054,000 @\$13,218	\$5,145,900 @\$11,236
30	\$6,073,000 @\$13,260	\$5,162,050 @\$11,271
31	\$6,091,000 @\$13,299	\$5,177,350 @\$11,304
32	\$6,109,000 @\$13,338	\$5,192,650 @\$11,338

**G : 2房 422'**

樓層	訂價	折實價15%
2	\$5,565,000 @\$13,187	\$4,730,250 @\$11,209
5	\$5,646,000 @\$13,379	\$4,799,100 @\$11,372
6	\$5,680,000 @\$13,460	\$4,828,000 @\$11,441
7	\$5,714,000 @\$13,540	\$4,856,900 @\$11,509
8	\$5,784,000 @\$13,706	\$4,916,400 @\$11,650
9	\$5,784,000 @\$13,706	\$4,916,400 @\$11,650
10	\$5,819,000 @\$13,789	\$4,946,150 @\$11,721
11	\$5,854,000 @\$13,872	\$4,975,900 @\$11,791
12	\$5,884,000 @\$13,943	\$5,001,400 @\$11,852
15	\$5,913,000 @\$14,012	\$5,026,050 @\$11,910
16	\$5,942,000 @\$14,081	\$5,050,700 @\$11,968

**J : 2房 433'**

樓層	訂價	折實價15%
2	\$5,355,000 @\$12,367	\$4,551,750 @\$10,512
3	\$5,471,000 @\$12,635	\$4,650,350 @\$10,740
5	\$5,520,000 @\$12,748	\$4,692,000 @\$10,836
6	\$5,569,000 @\$12,861	\$4,733,650 @\$10,932
7	\$5,604,000 @\$12,942	\$4,763,400 @\$11,001
8	\$5,672,000 @\$13,099	\$4,821,200 @\$11,134
9	\$5,672,000 @\$13,099	\$4,821,200 @\$11,134
10	\$5,706,000 @\$13,178	\$4,850,100 @\$11,201
11	\$5,740,000 @\$13,256	\$4,879,000 @\$11,268
12	\$5,769,000 @\$13,323	\$4,903,650 @\$11,325
15	\$5,798,000 @\$13,390	\$4,928,300 @\$11,382

紅色為最高售價、最高平均呎價；藍色為最低售價、最低平均呎價

# Tower 2

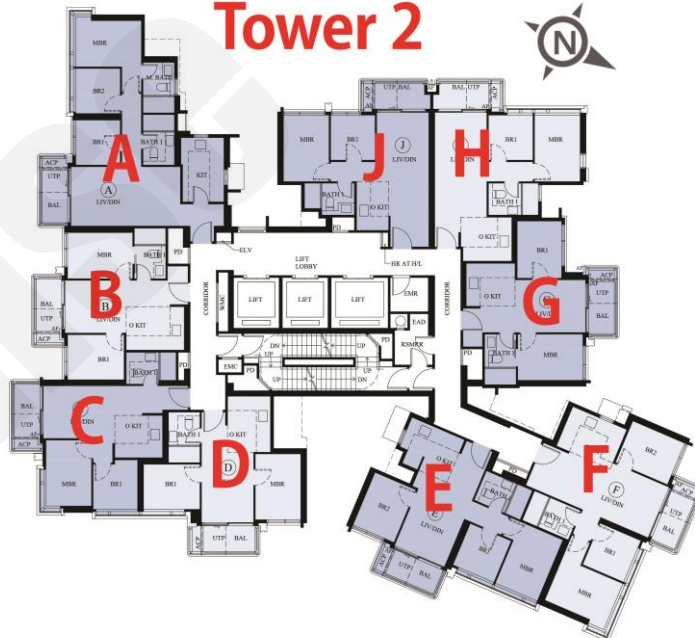

E : 3房 534'		
樓層	訂價	折實價15%
2	\$7,332,000 @\$13,730	\$6,232,200 @\$11,671
3	\$7,387,000 @\$13,833	\$6,278,950 @\$11,758
5	\$7,439,000 @\$13,931	\$6,323,150 @\$11,841
6	\$7,485,000 @\$14,017	\$6,362,250 @\$11,914
G2	\$7,212,000 @\$13,506	\$6,130,200 @\$11,480
H : 2房 458'		
樓層	訂價	折實價15%
2	\$5,528,000 @\$12,070	\$4,698,800 @\$10,259
3	\$5,579,000 @\$12,181	\$4,742,150 @\$10,354
5	\$5,629,000 @\$12,290	\$4,784,650 @\$10,447
6	\$5,680,000 @\$12,402	\$4,828,000 @\$10,541
7	\$5,715,000 @\$12,478	\$4,857,750 @\$10,606
8	\$5,785,000 @\$12,631	\$4,917,250 @\$10,736
9	\$5,785,000 @\$12,631	\$4,917,250 @\$10,736
10	\$5,819,000 @\$12,705	\$4,946,150 @\$10,799
11	\$5,854,000 @\$12,782	\$4,975,900 @\$10,864
12	\$5,884,000 @\$12,847	\$5,001,400 @\$10,920
15	\$5,913,000 @\$12,910	\$5,026,050 @\$10,974
16	\$5,944,000 @\$12,978	\$5,052,400 @\$11,031
18	\$5,996,000 @\$13,092	\$5,096,600 @\$11,128
19	\$5,996,000 @\$13,092	\$5,096,600 @\$11,128
20	\$6,014,000 @\$13,131	\$5,111,900 @\$11,161
21	\$6,033,000 @\$13,172	\$5,128,050 @\$11,197
22	\$6,051,000 @\$13,212	\$5,143,350 @\$11,230
25	\$6,087,000 @\$13,290	\$5,173,950 @\$11,297
27	\$6,124,000 @\$13,371	\$5,205,400 @\$11,366
G2	\$5,398,000 @\$11,786	\$4,588,300 @\$10,018

紅色為最高售價、最高平均呎價；藍色為最低售價、最低平均呎價

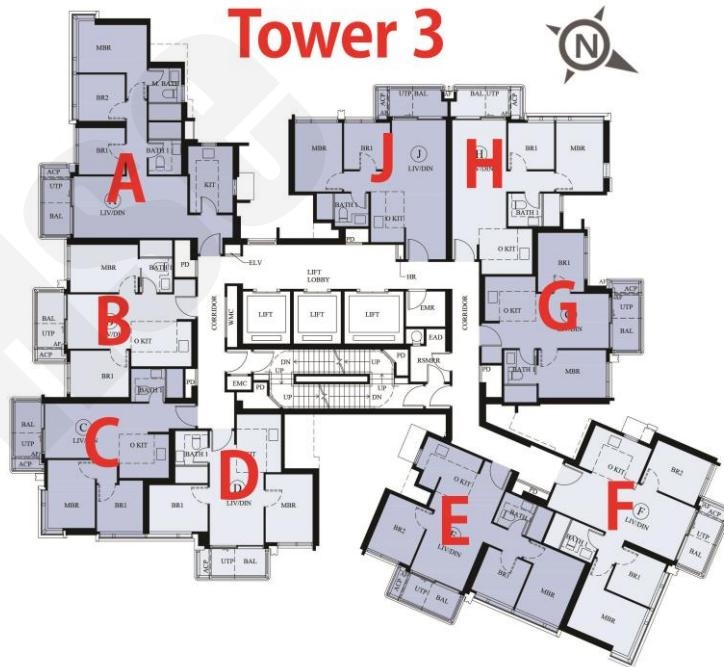

D : 2房 420'		
樓層	訂價	折實價15%
1	\$5,606,000 @\$13,348	\$4,765,100 @\$11,345
2	\$5,651,000 @\$13,455	\$4,803,350 @\$11,437
3	\$5,694,000 @\$13,557	\$4,839,900 @\$11,524
5	\$5,734,000 @\$13,652	\$4,873,900 @\$11,605
6	\$5,768,000 @\$13,733	\$4,902,800 @\$11,673
7	\$5,804,000 @\$13,819	\$4,933,400 @\$11,746
8	\$5,874,000 @\$13,986	\$4,992,900 @\$11,888
9	\$5,874,000 @\$13,986	\$4,992,900 @\$11,888
10	\$5,909,000 @\$14,069	\$5,022,650 @\$11,959
11	\$5,945,000 @\$14,155	\$5,053,250 @\$12,032
12	\$5,974,000 @\$14,224	\$5,077,900 @\$12,090
15	\$6,005,000 @\$14,298	\$5,104,250 @\$12,153
G2	\$5,558,000 @\$13,233	\$4,724,300 @\$11,248
C : 2房 434'/435'		
樓層	訂價	折實價15%
2	\$5,540,000 @\$12,736	\$4,709,000 @\$10,825
3	\$5,591,000 @\$12,853	\$4,752,350 @\$10,925
5	\$5,641,000 @\$12,968	\$4,794,850 @\$11,023
6	\$5,693,000 @\$13,087	\$4,839,050 @\$11,124
7	\$5,727,000 @\$13,166	\$4,867,950 @\$11,191
8	\$5,796,000 @\$13,324	\$4,926,600 @\$11,326
9	\$5,796,000 @\$13,324	\$4,926,600 @\$11,326
10	\$5,832,000 @\$13,407	\$4,957,200 @\$11,396
11	\$5,867,000 @\$13,487	\$4,986,950 @\$11,464
12	\$5,896,000 @\$13,554	\$5,011,600 @\$11,521
15	\$5,926,000 @\$13,623	\$5,037,100 @\$11,580
16	\$5,955,000 @\$13,690	\$5,061,750 @\$11,636
G2	\$5,428,000 @\$12,507	\$4,613,800 @\$10,631
E : 3房 534'		
樓層	訂價	折實價15%
6	\$7,285,000 @\$13,642	\$6,192,250 @\$11,596
7	\$7,329,000 @\$13,725	\$6,229,650 @\$11,666
8	\$7,418,000 @\$13,891	\$6,305,300 @\$11,808
9	\$7,418,000 @\$13,891	\$6,305,300 @\$11,808
10	\$7,464,000 @\$13,978	\$6,344,400 @\$11,881
G2	\$6,988,000 @\$13,086	\$5,939,800 @\$11,123

H : 2房 458'		
樓層	訂價	折實價15%
1	\$5,569,000 @\$12,159	\$4,733,650 @\$10,335
3	\$5,672,000 @\$12,384	\$4,821,200 @\$10,527
5	\$5,724,000 @\$12,498	\$4,865,400 @\$10,623
6	\$5,775,000 @\$12,609	\$4,908,750 @\$10,718
7	\$5,809,000 @\$12,683	\$4,937,650 @\$10,781
8	\$5,880,000 @\$12,838	\$4,998,000 @\$10,913
9	\$5,880,000 @\$12,838	\$4,998,000 @\$10,913
10	\$5,915,000 @\$12,915	\$5,027,750 @\$10,978
11	\$5,952,000 @\$12,996	\$5,059,200 @\$11,046
12	\$5,981,000 @\$13,059	\$5,083,850 @\$11,100
15	\$6,012,000 @\$13,127	\$5,110,200 @\$11,158
16	\$6,041,000 @\$13,190	\$5,134,850 @\$11,211
18	\$6,096,000 @\$13,310	\$5,181,600 @\$11,314
19	\$6,096,000 @\$13,310	\$5,181,600 @\$11,314
20	\$6,114,000 @\$13,349	\$5,196,900 @\$11,347
21	\$6,133,000 @\$13,391	\$5,213,050 @\$11,382
22	\$6,151,000 @\$13,430	\$5,228,350 @\$11,416
25	\$6,188,000 @\$13,511	\$5,259,800 @\$11,484
27	\$6,225,000 @\$13,592	\$5,291,250 @\$11,553
29	\$6,262,000 @\$13,672	\$5,322,700 @\$11,622

A : 3房 657'		
樓層	訂價	折實價15%
2	\$8,713,000 @\$13,262	\$7,406,050 @\$11,273
5	\$8,905,000 @\$13,554	\$7,569,250 @\$11,521
6	\$8,986,000 @\$13,677	\$7,638,100 @\$11,626
7	\$9,040,000 @\$13,760	\$7,684,000 @\$11,696
8	\$9,151,000 @\$13,928	\$7,778,350 @\$11,839
9	\$9,151,000 @\$13,928	\$7,778,350 @\$11,839
10	\$9,206,000 @\$14,012	\$7,825,100 @\$11,910
11	\$9,261,000 @\$14,096	\$7,871,850 @\$11,982
12	\$9,307,000 @\$14,166	\$7,910,950 @\$12,041

B : 2房 416'		
樓層	訂價	折實價15%
2	\$5,498,000 @\$13,216	\$4,673,300 @\$11,234
5	\$5,599,000 @\$13,459	\$4,759,150 @\$11,440
6	\$5,649,000 @\$13,579	\$4,801,650 @\$11,542
7	\$5,684,000 @\$13,663	\$4,831,400 @\$11,614
8	\$5,753,000 @\$13,829	\$4,890,050 @\$11,755
9	\$5,753,000 @\$13,829	\$4,890,050 @\$11,755
10	\$5,787,000 @\$13,911	\$4,918,950 @\$11,824
11	\$5,822,000 @\$13,995	\$4,948,700 @\$11,896
12	\$5,852,000 @\$14,067	\$4,974,200 @\$11,957

紅色為最高售價、最高平均呎價；藍色為最低售價、最低平均呎價

以上的物業資料只供參考，一切以發展商最新公布為準，如有任何資料錯漏本網頁不會承擔任何責任。