

Woodis

價單1號

以最高8%折扣計算

制作日期: 2025-10-08

A : 3房 598'		
樓層	訂價	折實價8%
5	\$13,793,000 @\$23,065	\$12,689,560 @\$21,220
6	\$14,075,000 @\$23,537	\$12,949,000 @\$21,654
7	\$14,358,000 @\$24,010	\$13,209,360 @\$22,089
10	\$15,206,000 @\$25,428	\$13,989,520 @\$23,394
11	\$15,489,000 @\$25,901	\$14,249,880 @\$23,829
12	\$15,715,000 @\$26,279	\$14,457,800 @\$24,177
15	\$15,884,000 @\$26,562	\$14,613,280 @\$24,437
16	\$15,997,000 @\$26,751	\$14,717,240 @\$24,611
17	\$16,110,000 @\$26,940	\$14,821,200 @\$24,785
18	\$16,336,000 @\$27,318	\$15,029,120 @\$25,132
19	\$16,562,000 @\$27,696	\$15,237,040 @\$25,480
20	\$16,798,000 @\$28,090	\$15,454,160 @\$25,843

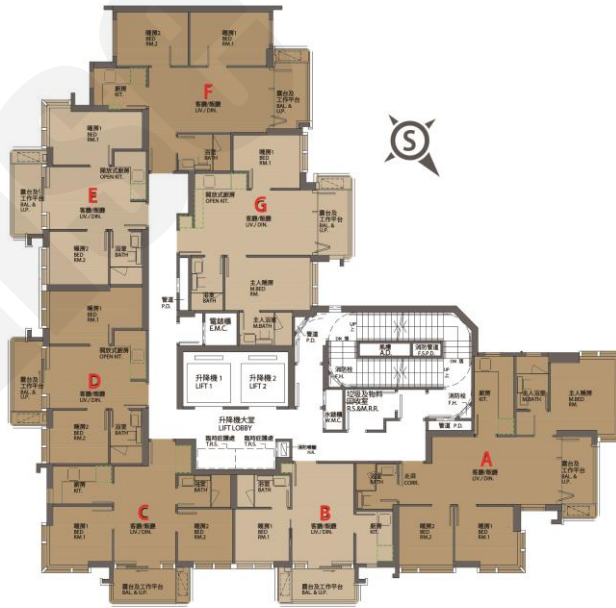

F : 2房 431'		
樓層	訂價	折實價8%
8	\$10,332,000 @\$23,972	\$9,505,440 @\$22,054
9	\$10,528,000 @\$24,427	\$9,685,760 @\$22,473
10	\$10,684,000 @\$24,789	\$9,829,280 @\$22,806
11	\$10,841,000 @\$25,153	\$9,973,720 @\$23,141
12	\$10,958,000 @\$25,425	\$10,081,360 @\$23,391
15	\$11,036,000 @\$25,606	\$10,153,120 @\$23,557
16	\$11,115,000 @\$25,789	\$10,225,800 @\$23,726
17	\$11,193,000 @\$25,970	\$10,297,560 @\$23,892
18	\$11,310,000 @\$26,241	\$10,405,200 @\$24,142
19	\$11,428,000 @\$26,515	\$10,513,760 @\$24,394
20	\$11,545,000 @\$26,787	\$10,621,400 @\$24,644
21	\$11,662,000 @\$27,058	\$10,729,040 @\$24,893
22	\$11,780,000 @\$27,332	\$10,837,600 @\$25,145

D : 2房 343'		
樓層	訂價	折實價8%
9	\$7,669,000 @\$22,359	\$7,055,480 @\$20,570
10	\$7,725,000 @\$22,522	\$7,107,000 @\$20,720
11	\$7,782,000 @\$22,688	\$7,159,440 @\$20,873
12	\$7,839,000 @\$22,854	\$7,211,880 @\$21,026
15	\$7,895,000 @\$23,017	\$7,263,400 @\$21,176
16	\$7,952,000 @\$23,184	\$7,315,840 @\$21,329
17	\$8,008,000 @\$23,347	\$7,367,360 @\$21,479
18	\$8,065,000 @\$23,513	\$7,419,800 @\$21,632
19	\$8,149,000 @\$23,758	\$7,497,080 @\$21,857
20	\$8,234,000 @\$24,006	\$7,575,280 @\$22,085
21	\$8,319,000 @\$24,254	\$7,653,480 @\$22,313
22	\$8,375,000 @\$24,417	\$7,705,000 @\$22,464
23	\$8,432,000 @\$24,583	\$7,757,440 @\$22,616

E : 2房 346'		
樓層	訂價	折實價8%
9	\$7,668,000 @\$22,162	\$7,054,560 @\$20,389
10	\$7,765,000 @\$22,442	\$7,143,800 @\$20,647
11	\$7,821,000 @\$22,604	\$7,195,320 @\$20,796
12	\$7,934,000 @\$22,931	\$7,299,280 @\$21,096
15	\$7,991,000 @\$23,095	\$7,351,720 @\$21,248
16	\$8,047,000 @\$23,257	\$7,403,240 @\$21,397
17	\$8,104,000 @\$23,422	\$7,455,680 @\$21,548
18	\$8,160,000 @\$23,584	\$7,507,200 @\$21,697
19	\$8,245,000 @\$23,829	\$7,585,400 @\$21,923
20	\$8,330,000 @\$24,075	\$7,663,600 @\$22,149
21	\$8,415,000 @\$24,321	\$7,741,800 @\$22,375
22	\$8,499,000 @\$24,564	\$7,819,080 @\$22,598

紅色為最高售價、最高平均呎價；藍色為最低售價、最低平均呎價
 以上的物業資料只供參考，一切以發展商最新公布為準，如有任何資料錯漏本網頁不會承擔任何責任。