

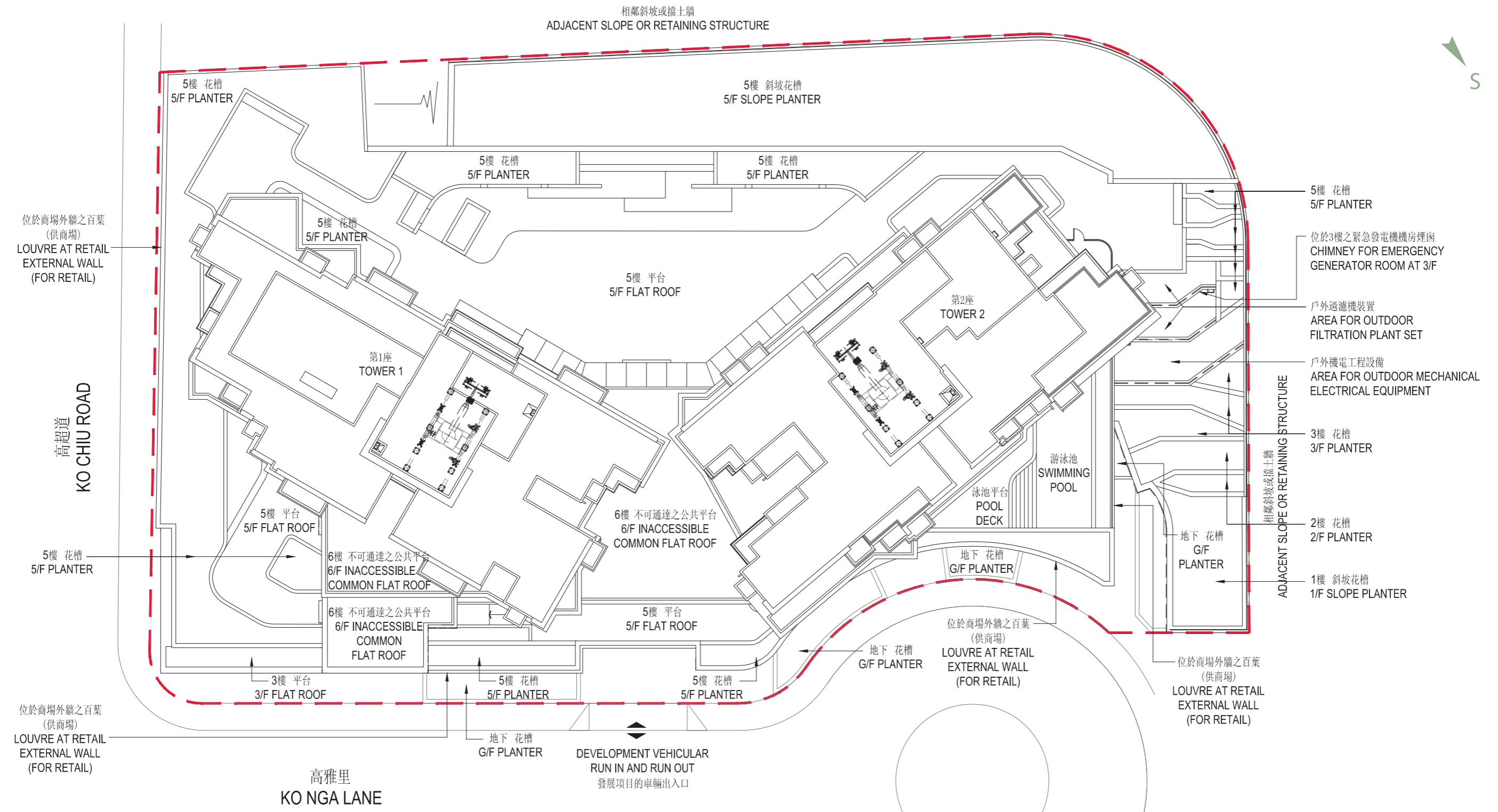

# 10

## LAYOUT PLAN OF THE DEVELOPMENT

### 發展項目的布局圖



Legend 圖例：

 Boundary line of the Development  
發展項目的界線

Scale : 0M/米  
比例： 20M/米

The estimated date of completion of the buildings and facilities within the Development, as provided by the Authorized Person for the Development is 31 December 2024.  
由發展項目的認可人士提供的位於發展項目內的建築物及設施的預計落成日期為2024年12月31日。