

9 發展項目的布局圖 LAYOUT PLAN OF THE DEVELOPMENT

圖例 Legend:

- 發展項目的第1期
Phase 1 of the Development
- 發展項目的第2期
Phase 2 of the Development
- 發展項目的第3期
Phase 3 of the Development
- 發展項目的界線
Boundary of the Development

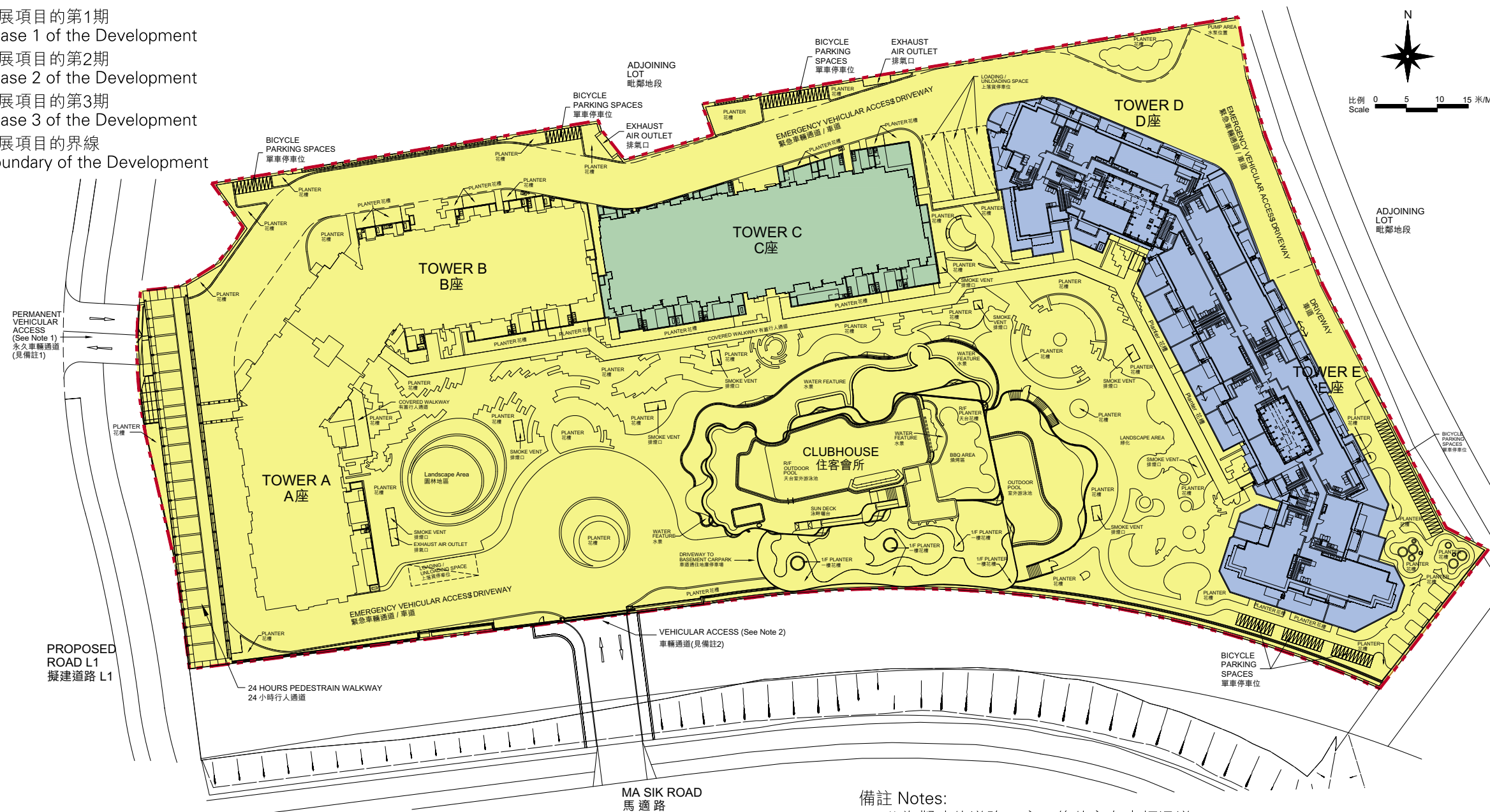

備註 Notes:

1. 此為擬建的道路L1完工後的永久車輛通道。
This is the permanent vehicular access after completion of the proposed road L1.
2. 由馬適路通往發展項目的車輛通道將在擬建道路L1竣工後及永久車輛通道啟用時關閉。
The vehicular access from Ma Sik Road to the development will be closed after the completion of the proposed road L1 and when the permanent vehicular access is in use.

由發展項目第1、2及3期的認可人士提供的位於發展項目第2及3期內的建築物及設施的預計落成日期為 2022年10月31日。
The estimated date of completion of the buildings and facilities within Phase 2 and 3 of the development as provided by the Authorized Person for Phase 1, 2 and 3 of the development is 31st October 2022.