

A-座 Tower A

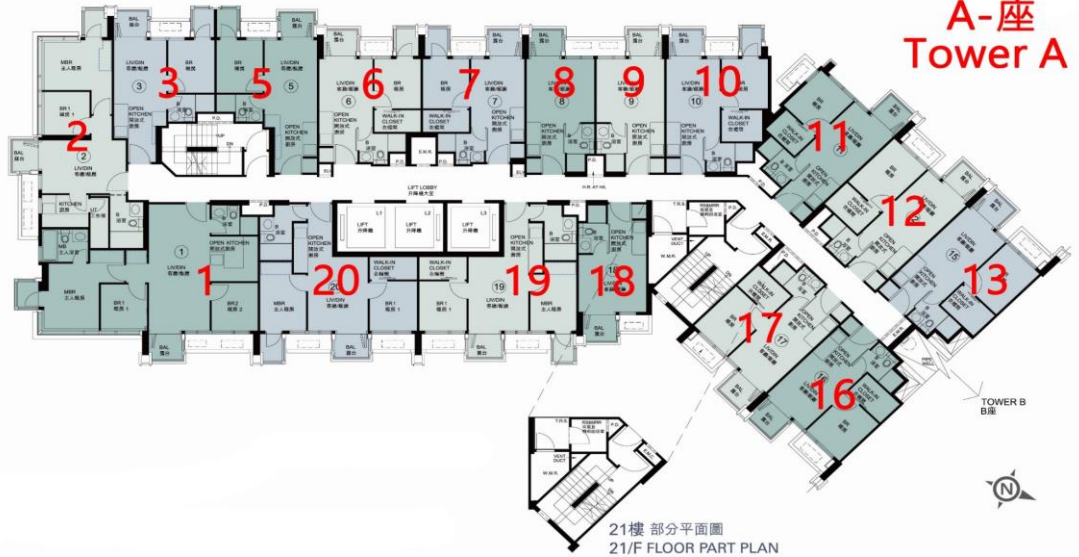

A座9：開放式 209'/226'

樓層	訂價	折實價7%
21	\$3,379,000 @\$16,167	\$3,142,470 @\$15,036
20	\$3,357,000 @\$16,062	\$3,122,010 @\$14,938
19	\$3,347,000 @\$16,014	\$3,112,710 @\$14,893
18	\$3,336,000 @\$15,962	\$3,102,480 @\$14,844
17	\$3,325,000 @\$15,909	\$3,092,250 @\$14,795
16	\$3,314,000 @\$15,856	\$3,082,020 @\$14,747
15	\$3,304,000 @\$15,809	\$3,072,720 @\$14,702
12	\$3,293,000 @\$15,756	\$3,062,490 @\$14,653
11	\$3,282,000 @\$15,703	\$3,052,260 @\$14,604
10	\$3,272,000 @\$15,656	\$3,042,960 @\$14,560
9	\$3,261,000 @\$15,603	\$3,032,730 @\$14,511
8	\$3,250,000 @\$15,550	\$3,022,500 @\$14,462
7	\$3,240,000 @\$15,502	\$3,013,200 @\$14,417
6	\$3,229,000 @\$15,450	\$3,002,970 @\$14,368
5	\$3,194,000 @\$15,282	\$2,970,420 @\$14,213
3	\$3,185,000 @\$14,093	\$2,962,050 @\$13,106

A座7：1房 284'

樓層	訂價	折實價7%
21	\$4,615,000 @\$16,250	\$4,291,950 @\$15,113
20	\$4,588,000 @\$16,155	\$4,266,840 @\$15,024
19	\$4,575,000 @\$16,109	\$4,254,750 @\$14,982
18	\$4,562,000 @\$16,063	\$4,242,660 @\$14,939
17	\$4,549,000 @\$16,018	\$4,230,570 @\$14,896
16	\$4,536,000 @\$15,972	\$4,218,480 @\$14,854
15	\$4,523,000 @\$15,926	\$4,206,390 @\$14,811
12	\$4,510,000 @\$15,880	\$4,194,300 @\$14,769
11	\$4,497,000 @\$15,835	\$4,182,210 @\$14,726
10	\$4,484,000 @\$15,789	\$4,170,120 @\$14,684
9	\$4,471,000 @\$15,743	\$4,158,030 @\$14,641
8	\$4,457,000 @\$15,694	\$4,145,010 @\$14,595
7	\$4,444,000 @\$15,648	\$4,132,920 @\$14,553

A座10：1房 309'

樓層	訂價	折實價7%
21	\$4,980,000 @\$16,117	\$4,631,400 @\$14,988
20	\$4,949,000 @\$16,016	\$4,602,570 @\$14,895
19	\$4,934,000 @\$15,968	\$4,588,620 @\$14,850
18	\$4,919,000 @\$15,919	\$4,574,670 @\$14,805
17	\$4,904,000 @\$15,871	\$4,560,720 @\$14,760
16	\$4,888,000 @\$15,819	\$4,545,840 @\$14,711
15	\$4,873,000 @\$15,770	\$4,531,890 @\$14,666
12	\$4,858,000 @\$15,722	\$4,517,940 @\$14,621
11	\$4,843,000 @\$15,673	\$4,503,990 @\$14,576
10	\$4,827,000 @\$15,621	\$4,489,110 @\$14,528
9	\$4,812,000 @\$15,573	\$4,475,160 @\$14,483
8	\$4,797,000 @\$15,524	\$4,461,210 @\$14,438
7	\$4,781,000 @\$15,472	\$4,446,330 @\$14,389
6	\$4,766,000 @\$15,424	\$4,432,380 @\$14,344
5	\$4,751,000 @\$15,375	\$4,418,430 @\$14,299

A座6：1房 285'

樓層	訂價	折實價7%
21	\$4,608,000 @\$16,168	\$4,285,440 @\$15,037
20	\$4,582,000 @\$16,077	\$4,261,260 @\$14,952
19	\$4,569,000 @\$16,032	\$4,249,170 @\$14,909
18	\$4,556,000 @\$15,986	\$4,237,080 @\$14,867
17	\$4,543,000 @\$15,940	\$4,224,990 @\$14,825
16	\$4,529,000 @\$15,891	\$4,211,970 @\$14,779
15	\$4,516,000 @\$15,846	\$4,199,880 @\$14,736
12	\$4,503,000 @\$15,800	\$4,187,790 @\$14,694
11	\$4,490,000 @\$15,754	\$4,175,700 @\$14,652
10	\$4,477,000 @\$15,709	\$4,163,610 @\$14,609
9	\$4,464,000 @\$15,663	\$4,151,520 @\$14,567
8	\$4,451,000 @\$15,618	\$4,139,430 @\$14,524
7	\$4,439,000 @\$15,575	\$4,128,270 @\$14,485

A座18：開放式 208'/247'

樓層	訂價	折實價7%
21	\$3,475,000 @\$16,707	\$3,231,750 @\$15,537
20	\$3,453,000 @\$16,601	\$3,211,290 @\$15,439
19	\$3,436,000 @\$16,519	\$3,195,480 @\$15,363
18	\$3,420,000 @\$16,442	\$3,180,600 @\$15,291
17	\$3,409,000 @\$16,389	\$3,170,370 @\$15,242
16	\$3,398,000 @\$16,337	\$3,160,140 @\$15,193
15	\$3,385,000 @\$16,274	\$3,148,050 @\$15,135
9	\$3,344,000 @\$16,077	\$3,109,920 @\$14,952
8	\$3,333,000 @\$16,024	\$3,099,690 @\$14,902
7	\$3,322,000 @\$15,971	\$3,089,460 @\$14,853
6	\$3,311,000 @\$15,918	\$3,079,230 @\$14,804
5	\$3,300,000 @\$15,865	\$3,069,000 @\$14,755
3	\$3,289,000 @\$15,813	\$3,058,770 @\$14,706
2	\$3,267,000 @\$15,707	\$3,038,310 @\$14,607
1	\$3,245,000 @\$15,601	\$3,017,850 @\$14,509
G	\$4,383,000 @\$17,745	\$4,076,190 @\$16,503

A座5：1房 295'

樓層	訂價	折實價7%
21	\$4,774,000 @\$16,183	\$4,439,820 @\$15,050
20	\$4,748,000 @\$16,095	\$4,415,640 @\$14,968
19	\$4,735,000 @\$16,051	\$4,403,550 @\$14,927
18	\$4,721,000 @\$16,003	\$4,390,530 @\$14,883
17	\$4,708,000 @\$15,959	\$4,378,440 @\$14,842
16	\$4,695,000 @\$15,915	\$4,366,350 @\$14,801
15	\$4,682,000 @\$15,871	\$4,354,260 @\$14,760
12	\$4,669,000 @\$15,827	\$4,342,170 @\$14,719
11	\$4,656,000 @\$15,783	\$4,330,080 @\$14,678
10	\$4,643,000 @\$15,739	\$4,317,990 @\$14,637
9	\$4,630,000 @\$15,695	\$4,305,900 @\$14,596
8	\$4,617,000 @\$15,651	\$4,293,810 @\$14,555
7	\$4,604,000 @\$15,607	\$4,281,720 @\$14,514
6	\$4,591,000 @\$15,563	\$4,269,630 @\$14,473
5	\$4,577,000 @\$15,515	\$4,256,610 @\$14,429
3	\$4,558,000 @\$15,451	\$4,238,940 @\$14,369

A座1：3房連套房 609'

樓層	訂價	折實價7%
21	\$9,298,000 @\$15,268	\$8,647,140 @\$14,199
20	\$9,243,000 @\$15,177	\$8,595,990 @\$14,115
19	\$9,405,000 @\$15,443	\$8,746,650 @\$14,362
18	\$9,363,000 @\$15,374	\$8,707,590 @\$14,298
17	\$9,334,000 @\$15,327	\$8,680,620 @\$14,254
16	\$9,306,000 @\$15,281	\$8,654,580 @\$14,211
15	\$9,076,000 @\$14,903	\$8,440,680 @\$13,860
12	\$9,229,000 @\$15,154	\$8,582,970 @\$14,094
11	\$9,201,000 @\$15,108	\$8,556,930 @\$14,051
10	\$9,172,000 @\$15,061	\$8,529,960 @\$14,007
3	\$9,002,000 @\$14,782	\$8,371,860 @\$13,747
2	\$8,970,000 @\$14,729	\$8,342,100 @\$13,698

A座20：2房 423'

樓層	訂價	折實價7%
21	\$6,718,000 @\$15,882	\$6,247,740 @\$14,770
20	\$6,679,000 @\$15,790	\$6,211,470 @\$14,684
19	\$6,783,000 @\$16,035	\$6,308,190 @\$14,913
18	\$6,754,000 @\$15,967	\$6,281,220 @\$14,849
17	\$6,734,000 @\$15,920	\$6,262,620 @\$14,805
16	\$6,583,000 @\$15,563	\$6,122,190 @\$14,473
15	\$6,564,000 @\$15,518	\$6,104,520 @\$14,431
12	\$6,675,000 @\$15,780	\$6,207,750 @\$14,676
11	\$6,656,000 @\$15,735	\$6,190,080 @\$14,634
10	\$6,636,000 @\$15,688	\$6,171,480 @\$14,590
9	\$6,616,000 @\$15,641	\$6,152,880 @\$14,546
8	\$6,597,000 @\$15,596	\$6,135,210 @\$14,504
7	\$6,577,000 @\$15,548	\$6,116,610 @\$14,460
6	\$6,557,000 @\$15,501	\$6,098,010 @\$14,416
5	\$6,538,000 @\$15,456	\$6,080,340 @\$14,374
3	\$6,528,000 @\$15,433	\$6,071,040 @\$14,352
2	\$6,508,000 @\$15,385	\$6,052,440 @\$14,308
1	\$6,479,000 @\$15,317	\$6,025,470 @\$14,245

紅色為最高售價、最高平均呎價；藍色為最低售價、最低平均呎價

以上的物業資料只供參考，一切以發展商最新公布為準，如有任何資料錯漏本網頁不會承擔任何責任。

B座22: 1房 290'328'		
樓層	訂價	折實價7%
22	\$6,150,000 @\$18,750	\$5,719,500 @\$17,438
21	\$5,134,000 @\$15,652	\$4,774,620 @\$14,557
20	\$5,104,000 @\$15,561	\$4,746,720 @\$14,472
19	\$5,089,000 @\$15,515	\$4,732,770 @\$14,429
18	\$5,074,000 @\$15,470	\$4,718,820 @\$14,387
17	\$5,059,000 @\$15,424	\$4,704,870 @\$14,344
16	\$5,044,000 @\$15,378	\$4,690,920 @\$14,302
15	\$5,029,000 @\$15,332	\$4,676,970 @\$14,259
12	\$5,014,000 @\$15,287	\$4,663,020 @\$14,217
11	\$4,999,000 @\$15,241	\$4,649,070 @\$14,174
10	\$4,984,000 @\$15,195	\$4,635,120 @\$14,131
9	\$4,969,000 @\$15,149	\$4,621,170 @\$14,089
8	\$4,954,000 @\$15,104	\$4,607,220 @\$14,046
7	\$4,939,000 @\$15,058	\$4,593,270 @\$14,004
6	\$4,924,000 @\$15,012	\$4,579,320 @\$13,961
5	\$4,909,000 @\$14,966	\$4,565,370 @\$13,919
3	\$4,894,000 @\$14,921	\$4,551,420 @\$13,876
2	\$4,879,000 @\$14,875	\$4,537,470 @\$13,834
1	\$4,864,000 @\$14,829	\$4,523,520 @\$13,791
G	\$5,463,000 @\$18,838	\$5,080,590 @\$15,719

B座19: 1房 309'315'		
樓層	訂價	折實價7%
22	\$5,377,000 @\$17,401	\$5,000,610 @\$16,183
21	\$4,954,000 @\$15,727	\$4,607,220 @\$14,626
20	\$4,923,000 @\$15,629	\$4,578,390 @\$14,535
19	\$4,908,000 @\$15,581	\$4,564,440 @\$14,490
18	\$4,893,000 @\$15,533	\$4,550,490 @\$14,446
17	\$4,877,000 @\$15,483	\$4,535,610 @\$14,399
16	\$4,862,000 @\$15,435	\$4,521,660 @\$14,354
15	\$4,847,000 @\$15,387	\$4,507,710 @\$14,310
12	\$4,832,000 @\$15,340	\$4,493,760 @\$14,266
11	\$4,816,000 @\$15,289	\$4,478,880 @\$14,219
10	\$4,801,000 @\$15,241	\$4,464,930 @\$14,174
9	\$4,786,000 @\$15,194	\$4,450,980 @\$14,130
8	\$4,771,000 @\$15,146	\$4,437,030 @\$14,086
7	\$4,755,000 @\$15,095	\$4,422,150 @\$14,039
6	\$4,740,000 @\$15,048	\$4,408,200 @\$13,994
5	\$4,725,000 @\$15,000	\$4,394,250 @\$13,950
3	\$4,709,000 @\$14,949	\$4,379,370 @\$13,903
2	\$4,694,000 @\$14,902	\$4,365,420 @\$13,858



21樓部分平面圖
21/F FLOOR PART PLAN

B座18: 1房 310'		
樓層	訂價	折實價7%
22	\$5,209,000 @\$16,803	\$4,844,370 @\$15,627
21	\$4,824,000 @\$15,561	\$4,486,320 @\$14,472
20	\$4,798,000 @\$15,477	\$4,462,140 @\$14,394
19	\$4,785,000 @\$15,435	\$4,450,050 @\$14,355
18	\$4,772,000 @\$15,394	\$4,437,960 @\$14,316
17	\$4,759,000 @\$15,352	\$4,425,870 @\$14,277
16	\$4,745,000 @\$15,306	\$4,412,850 @\$14,235
15	\$4,732,000 @\$15,265	\$4,400,760 @\$14,196
12	\$4,719,000 @\$15,223	\$4,388,670 @\$14,157
11	\$4,706,000 @\$15,181	\$4,376,580 @\$14,118
10	\$4,693,000 @\$15,139	\$4,364,490 @\$14,079
9	\$4,680,000 @\$15,097	\$4,352,400 @\$14,040
8	\$4,667,000 @\$15,055	\$4,340,310 @\$14,001
7	\$4,654,000 @\$15,013	\$4,328,220 @\$13,962
6	\$4,641,000 @\$14,971	\$4,316,130 @\$13,923
5	\$4,628,000 @\$14,929	\$4,304,040 @\$13,884
3	\$4,615,000 @\$14,887	\$4,291,950 @\$13,845
2	\$4,611,000 @\$14,874	\$4,288,230 @\$13,833

B座16: 1房 329'		
樓層	訂價	折實價7%
22	\$5,760,000 @\$17,508	\$5,356,800 @\$16,282
16	\$4,919,000 @\$14,951	\$4,574,670 @\$13,905
15	\$4,904,000 @\$14,906	\$4,560,720 @\$13,862
12	\$4,889,000 @\$14,860	\$4,546,770 @\$13,820
11	\$4,874,000 @\$14,815	\$4,532,820 @\$13,778
10	\$4,859,000 @\$14,769	\$4,518,870 @\$13,735
9	\$4,844,000 @\$14,723	\$4,504,920 @\$13,693
8	\$4,829,000 @\$14,678	\$4,490,970 @\$13,650
7	\$4,814,000 @\$14,632	\$4,477,020 @\$13,608
6	\$4,799,000 @\$14,587	\$4,463,070 @\$13,566
5	\$4,784,000 @\$14,541	\$4,449,120 @\$13,523

B座17: 1房 320'		
樓層	訂價	折實價7%
22	\$5,400,000 @\$16,875	\$5,022,000 @\$15,694
21	\$4,988,000 @\$15,588	\$4,638,840 @\$14,496
20	\$4,967,000 @\$15,522	\$4,619,310 @\$14,435
19	\$4,952,000 @\$15,475	\$4,605,360 @\$14,392
18	\$4,936,000 @\$15,425	\$4,590,480 @\$14,345
17	\$4,921,000 @\$15,378	\$4,576,530 @\$14,302
16	\$4,906,000 @\$15,331	\$4,562,580 @\$14,258
15	\$4,891,000 @\$15,284	\$4,548,630 @\$14,214
12	\$4,875,000 @\$15,234	\$4,533,750 @\$14,168
11	\$4,860,000 @\$15,188	\$4,519,800 @\$14,124
10	\$4,845,000 @\$15,141	\$4,505,850 @\$14,081
9	\$4,829,000 @\$15,091	\$4,490,970 @\$14,034
8	\$4,814,000 @\$15,044	\$4,477,020 @\$13,991
7	\$4,799,000 @\$14,997	\$4,463,070 @\$13,947
6	\$4,784,000 @\$14,950	\$4,449,120 @\$13,904
5	\$4,768,000 @\$14,900	\$4,434,240 @\$13,857
3	\$4,762,000 @\$14,881	\$4,428,660 @\$13,840
2	\$4,756,000 @\$14,863	\$4,423,080 @\$13,822

B座15: 1房 328'329'		
樓層	訂價	折實價7%
22	\$5,806,000 @\$17,647	\$5,399,580 @\$16,412
21	\$4,993,000 @\$15,223	\$4,643,490 @\$14,157
20	\$4,963,000 @\$15,131	\$4,615,590 @\$14,072
19	\$4,948,000 @\$15,085	\$4,601,640 @\$14,029
18	\$4,933,000 @\$15,040	\$4,587,690 @\$13,987
17	\$4,918,000 @\$14,994	\$4,573,740 @\$13,944
16	\$4,903,000 @\$14,948	\$4,559,790 @\$13,902
15	\$4,888,000 @\$14,902	\$4,545,840 @\$13,859
12	\$4,873,000 @\$14,857	\$4,531,890 @\$13,817
11	\$4,858,000 @\$14,811	\$4,517,940 @\$13,774
10	\$4,843,000 @\$14,765	\$4,503,990 @\$13,732
9	\$4,828,000 @\$14,720	\$4,490,040 @\$13,689
8	\$4,813,000 @\$14,674	\$4,476,090 @\$13,647
7	\$4,798,000 @\$14,628	\$4,462,140 @\$13,604
6	\$4,783,000 @\$14,582	\$4,448,190 @\$13,562
5	\$4,768,000 @\$14,537	\$4,434,240 @\$13,519
3	\$4,753,000 @\$14,491	\$4,420,290 @\$13,476
2	\$4,738,000 @\$14,401	\$4,406,340 @\$13,393
1	\$4,723,000 @\$14,356	\$4,392,390 @\$13,351

紅色為最高售價、最高平均呎價；藍色為最低售價、最低平均呎價

以上的物業資料只供參考，一切以發展商最新公布為準，如有任何資料錯漏本網頁不會承擔任何責任。



B座15: 1房 328/329'		
樓層	訂價	折實價7%
22	\$5,806,000 @\$17,647	\$5,399,580 @\$16,412
21	\$4,993,000 @\$15,223	\$4,643,490 @\$14,157
20	\$4,963,000 @\$15,131	\$4,615,590 @\$14,072
19	\$4,948,000 @\$15,085	\$4,601,640 @\$14,029
18	\$4,933,000 @\$15,040	\$4,587,690 @\$13,987
17	\$4,918,000 @\$14,994	\$4,573,740 @\$13,944
16	\$4,903,000 @\$14,948	\$4,559,790 @\$13,902
15	\$4,888,000 @\$14,902	\$4,545,840 @\$13,859
12	\$4,873,000 @\$14,857	\$4,531,890 @\$13,817
11	\$4,858,000 @\$14,811	\$4,517,940 @\$13,774
10	\$4,843,000 @\$14,765	\$4,503,990 @\$13,732
9	\$4,828,000 @\$14,720	\$4,490,040 @\$13,689
8	\$4,813,000 @\$14,674	\$4,476,090 @\$13,647
7	\$4,798,000 @\$14,628	\$4,462,140 @\$13,604
6	\$4,783,000 @\$14,582	\$4,448,190 @\$13,562
5	\$4,768,000 @\$14,537	\$4,434,240 @\$13,519
3	\$4,753,000 @\$14,491	\$4,420,290 @\$13,476
2	\$4,738,000 @\$14,445	\$4,406,340 @\$13,433
1	\$4,723,000 @\$14,399	\$4,392,390 @\$13,390

B座5: 2房連套房 458'		
樓層	訂價	折實價7%
21	\$7,161,000 @\$15,635	\$6,659,730 @\$14,541
20	\$7,119,000 @\$15,544	\$6,620,670 @\$14,456
19	\$7,239,000 @\$15,806	\$6,732,270 @\$14,699
18	\$7,217,000 @\$15,758	\$6,711,810 @\$14,655
17	\$7,196,000 @\$15,712	\$6,692,280 @\$14,612
16	\$7,033,000 @\$15,356	\$6,540,690 @\$14,281
15	\$7,012,000 @\$15,310	\$6,521,160 @\$14,238
12	\$7,130,000 @\$15,568	\$6,630,900 @\$14,478
11	\$7,108,000 @\$15,520	\$6,610,440 @\$14,433
10	\$7,087,000 @\$15,474	\$6,590,910 @\$14,391
9	\$7,065,000 @\$15,426	\$6,570,450 @\$14,346
8	\$7,043,000 @\$15,378	\$6,549,990 @\$14,301
7	\$7,021,000 @\$15,330	\$6,529,530 @\$14,257
6	\$6,999,000 @\$15,282	\$6,509,070 @\$14,212
5	\$6,977,000 @\$15,234	\$6,488,610 @\$14,167
3	\$6,956,000 @\$15,188	\$6,469,080 @\$14,125
2	\$6,934,000 @\$15,140	\$6,448,620 @\$14,080
1	\$6,901,000 @\$15,088	\$6,417,930 @\$14,013

B座3: 1房 310'		
樓層	訂價	折實價7%
21	\$5,116,000 @\$16,503	\$4,757,880 @\$15,348
20	\$5,086,000 @\$16,406	\$4,729,980 @\$15,258
19	\$5,071,000 @\$16,358	\$4,716,030 @\$15,213
18	\$5,055,000 @\$16,306	\$4,701,150 @\$15,165
17	\$5,040,000 @\$16,258	\$4,687,200 @\$15,120
16	\$5,025,000 @\$16,210	\$4,673,250 @\$15,075
15	\$5,009,000 @\$16,158	\$4,658,370 @\$15,027

B座2: 1房 272/310'		
樓層	訂價	折實價7%
21	\$5,111,000 @\$16,487	\$4,753,230 @\$15,333
20	\$5,080,000 @\$16,387	\$4,724,400 @\$15,240
19	\$5,065,000 @\$16,339	\$4,710,450 @\$15,195
18	\$5,050,000 @\$16,290	\$4,696,500 @\$15,150
17	\$5,035,000 @\$16,242	\$4,682,550 @\$15,105
16	\$5,019,000 @\$16,190	\$4,667,670 @\$15,057
15	\$5,004,000 @\$16,142	\$4,653,720 @\$15,012
12	\$4,989,000 @\$16,094	\$4,639,770 @\$14,967
11	\$4,973,000 @\$16,042	\$4,624,890 @\$14,919
10	\$4,958,000 @\$15,994	\$4,610,940 @\$14,874
9	\$4,943,000 @\$15,945	\$4,596,990 @\$14,829
8	\$4,928,000 @\$15,897	\$4,583,040 @\$14,784
7	\$4,912,000 @\$15,845	\$4,568,160 @\$14,736
6	\$4,897,000 @\$15,797	\$4,554,210 @\$14,691
5	\$4,882,000 @\$15,748	\$4,540,260 @\$14,646
3	\$4,867,000 @\$15,700	\$4,526,310 @\$14,601
2	\$4,851,000 @\$15,648	\$4,511,430 @\$14,553
1	\$4,828,000 @\$15,574	\$4,490,040 @\$14,484
G	\$5,620,000 @\$20,662	\$5,226,600 @\$19,215

B座21: 1房 329'		
樓層	訂價	折實價7%
21	\$5,075,000 @\$15,426	\$4,719,750 @\$14,346
20	\$5,045,000 @\$15,334	\$4,691,850 @\$14,261
19	\$5,030,000 @\$15,289	\$4,677,900 @\$14,219
18	\$5,015,000 @\$15,243	\$4,663,950 @\$14,176
17	\$5,000,000 @\$15,198	\$4,650,000 @\$14,134
16	\$4,985,000 @\$15,152	\$4,636,050 @\$14,091
15	\$4,970,000 @\$15,106	\$4,622,100 @\$14,049
12	\$4,955,000 @\$15,061	\$4,608,150 @\$14,007
11	\$4,940,000 @\$15,015	\$4,594,200 @\$13,964
10	\$4,925,000 @\$14,970	\$4,580,250 @\$13,922
9	\$4,910,000 @\$14,924	\$4,566,300 @\$13,879
8	\$4,895,000 @\$14,878	\$4,552,350 @\$13,837
7	\$4,880,000 @\$14,833	\$4,538,400 @\$13,795
6	\$4,865,000 @\$14,787	\$4,524,450 @\$13,752
5	\$4,850,000 @\$14,742	\$4,510,500 @\$13,710
3	\$4,835,000 @\$14,696	\$4,496,550 @\$13,667
2	\$4,820,000 @\$14,650	\$4,482,600 @\$13,625
1	\$4,805,000 @\$14,605	\$4,468,650 @\$13,583

B座20: 1房 315'		
樓層	訂價	折實價7%
21	\$4,857,000 @\$15,419	\$4,517,010 @\$14,340
20	\$4,827,000 @\$15,324	\$4,489,110 @\$14,251
19	\$4,812,000 @\$15,276	\$4,475,160 @\$14,207
18	\$4,797,000 @\$15,229	\$4,461,210 @\$14,163
17	\$4,782,000 @\$15,181	\$4,447,260 @\$14,118
16	\$4,767,000 @\$15,133	\$4,433,310 @\$14,074
15	\$4,752,000 @\$15,086	\$4,419,360 @\$14,030
12	\$4,737,000 @\$15,038	\$4,405,410 @\$13,985
11	\$4,722,000 @\$14,990	\$4,391,460 @\$13,941
10	\$4,707,000 @\$14,943	\$4,377,510 @\$13,897
9	\$4,692,000 @\$14,895	\$4,363,560 @\$13,853
8	\$4,677,000 @\$14,848	\$4,349,610 @\$13,808
7	\$4,662,000 @\$14,800	\$4,335,660 @\$13,764
6	\$4,647,000 @\$14,752	\$4,321,710 @\$13,720
5	\$4,632,000 @\$14,705	\$4,307,760 @\$13,675
3	\$4,617,000 @\$14,657	\$4,293,810 @\$13,631
2	\$4,602,000 @\$14,606	\$4,279,860 @\$13,584
1	\$4,588,000 @\$14,565	\$4,266,840 @\$13,546

紅色為最高售價、最高平均呎價；藍色為最低售價、最低平均呎價

以上的物業資料只供參考，一切以發展商最新公布為準，如有任何資料錯漏本網頁不會承擔任何責任。

新盤價單表

One Innovale Archway

價單1,2,3號

以最高7%折扣計算

制作日期: 2022-08-03

B座1: 1房 284'/321'		
樓層	訂價	折實價7%
21	\$5,354,000 @\$16,679	\$4,979,220 @\$15,512
20	\$5,324,000 @\$16,586	\$4,951,320 @\$15,425
19	\$5,309,000 @\$16,539	\$4,937,370 @\$15,381
18	\$5,294,000 @\$16,492	\$4,923,420 @\$15,338
17	\$5,279,000 @\$16,445	\$4,909,470 @\$15,294
16	\$5,264,000 @\$16,399	\$4,895,520 @\$15,251
15	\$5,249,000 @\$16,352	\$4,881,570 @\$15,207
12	\$5,234,000 @\$16,305	\$4,867,620 @\$15,164
11	\$5,219,000 @\$16,259	\$4,853,670 @\$15,120
10	\$5,204,000 @\$16,212	\$4,839,720 @\$15,077
9	\$5,189,000 @\$16,165	\$4,825,770 @\$15,034
8	\$5,174,000 @\$16,118	\$4,811,820 @\$14,990
7	\$5,159,000 @\$16,072	\$4,797,870 @\$14,947
6	\$5,144,000 @\$16,025	\$4,783,920 @\$14,903
G	\$6,212,000 @\$21,873	\$5,777,160 @\$20,342



紅色為最高售價、最高平均呎價；藍色為最低售價、最低平均呎價

以上的物業資料只供參考，一切以發展商最新公布為準，如有任何資料錯漏本網頁不會承擔任何責任。