

10 LAYOUT PLAN OF THE DEVELOPMENT

發展項目的布局圖

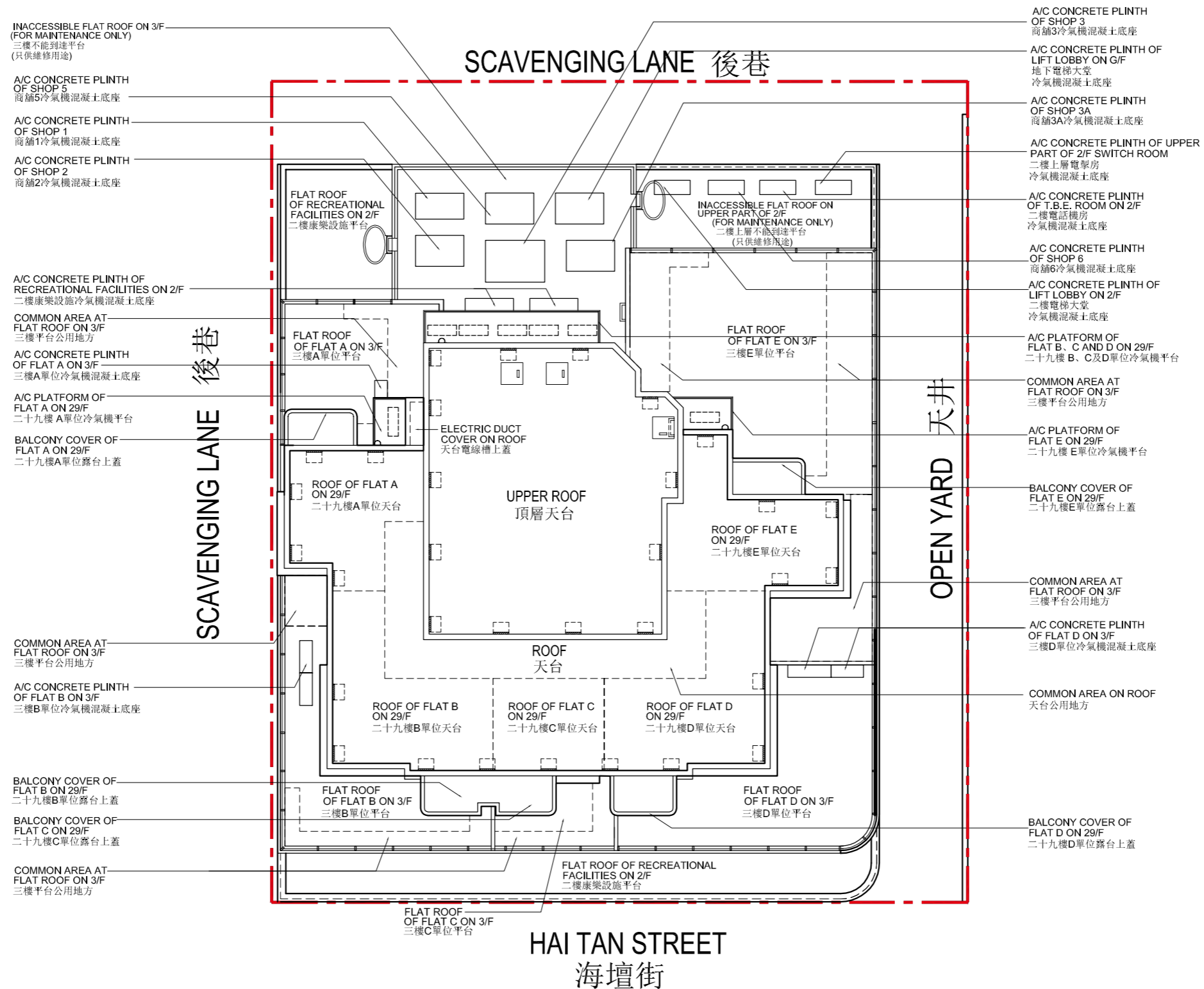

Boundary line of the Development
發展項目界線

-  = Air Conditioner outdoor unit
冷氣機室外機
-  = Davit arm rack
吊船吊臂架

- A/C PLATFORM = Air conditioner Platform
冷氣機平台
- T.B.E. ROOM = Telecommunications and Broadcasting Room
電話機房
- A/C CONCRETE PLINTH = Air conditioner Concrete Plinth
冷氣機混凝土底座

Scale 0 5M(米) 

The estimated date of completion of the building and facilities as provided by the Authorized Person for the Development: 31 December 2023
發展項目的認可人士提供的建築物及設施的預計落成日期：2023年12月31日