

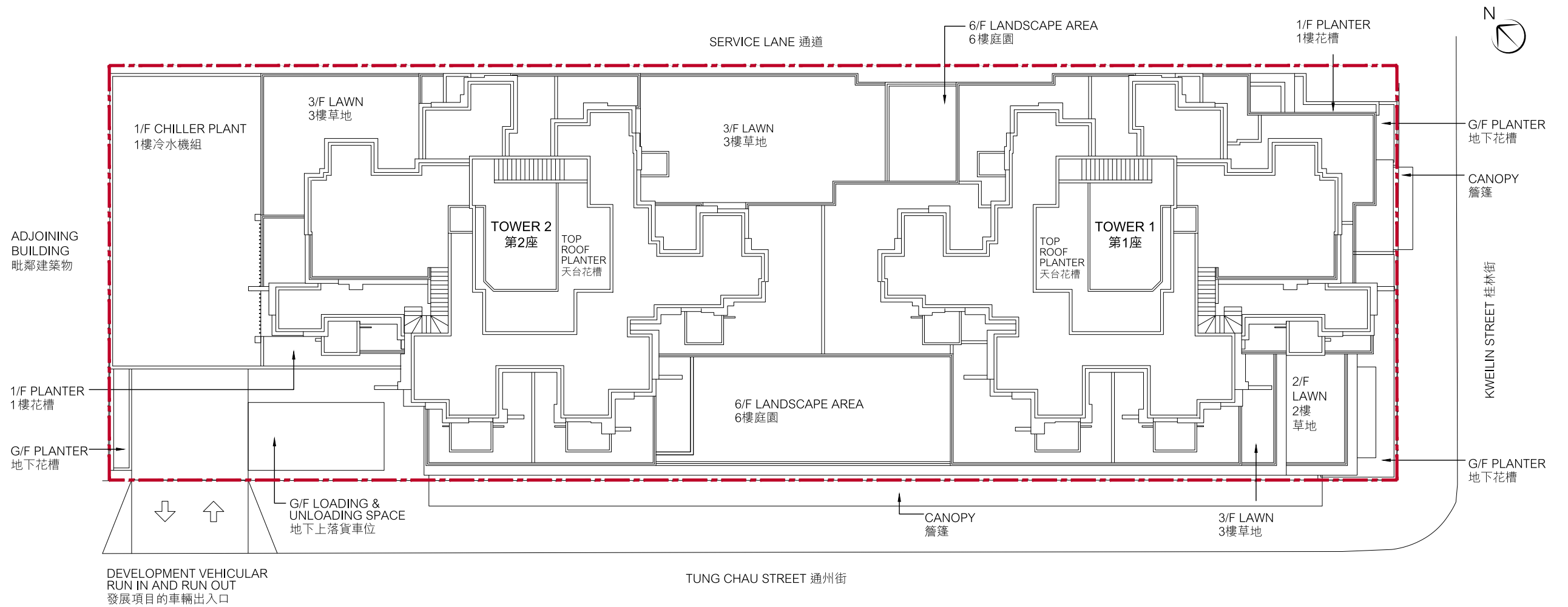

9 發展項目的布局圖 LAYOUT PLAN OF THE DEVELOPMENT



圖例 LEGEND

-  發展項目的界線
Boundary of the Development

比例尺 Scale  0米 (m) 20米 (m)

由發展項目的認可人士提供的位於發展項目的界線之內的建築物及設施的預計落成日期為2023年5月20日。
The estimated date of completion of the buildings and facilities within the boundary of the Development, as provided by the authorized person for the Development is 20th May 2023.