

B6 : 3房 578'		
樓層	訂價	折實價17.5%
11	\$12,573,900 @ \$21,754	\$10,373,468 @ \$17,947
10	\$12,498,900 @ \$21,624	\$10,311,593 @ \$17,840
9	\$12,424,400 @ \$21,496	\$10,250,130 @ \$17,734
8	\$12,374,900 @ \$21,410	\$10,209,293 @ \$17,663
7	\$12,350,200 @ \$21,367	\$10,188,915 @ \$17,628
6	\$12,325,500 @ \$21,324	\$10,168,538 @ \$17,593
5	\$12,300,900 @ \$21,282	\$10,148,243 @ \$17,558
3	\$12,227,100 @ \$21,154	\$10,087,358 @ \$17,452
2	\$12,129,300 @ \$20,985	\$10,006,673 @ \$17,313

B5 : 2房 403'/408'		
樓層	訂價	折實價17.5%
11	\$9,061,000 @ \$22,484	\$7,475,325 @ \$18,549
10	\$9,006,900 @ \$22,350	\$7,430,693 @ \$18,438
9	\$8,953,200 @ \$22,216	\$7,386,390 @ \$18,329
8	\$8,917,500 @ \$22,128	\$7,356,938 @ \$18,255
7	\$8,899,700 @ \$22,084	\$7,342,253 @ \$18,219
6	\$8,882,000 @ \$22,040	\$7,327,650 @ \$18,183
5	\$8,864,200 @ \$21,996	\$7,312,965 @ \$18,146
3	\$8,811,000 @ \$21,864	\$7,269,075 @ \$18,037
2	\$8,740,500 @ \$21,689	\$7,210,913 @ \$17,893
1	\$8,778,200 @ \$21,515	\$7,242,015 @ \$17,750

B2 : 1房 285'		
樓層	訂價	折實價17.5%
9	\$6,884,500 @ \$24,156	\$5,679,713 @ \$19,929
8	\$6,857,000 @ \$24,060	\$5,657,025 @ \$19,849
7	\$6,843,300 @ \$24,012	\$5,645,723 @ \$19,810
6	\$6,829,700 @ \$23,964	\$5,634,503 @ \$19,770
5	\$6,816,000 @ \$23,916	\$5,623,200 @ \$19,731
3	\$6,775,100 @ \$23,772	\$5,589,458 @ \$19,612
2	\$6,720,900 @ \$23,582	\$5,544,743 @ \$19,455
1	\$6,658,000 @ \$23,361	\$5,492,850 @ \$19,273

B1 : 3房連套房及工人套房 729/770'		
樓層	訂價	折實價17.5%
6	\$15,654,700 @ \$20,331	\$12,915,128 @ \$16,773
5	\$15,568,600 @ \$20,219	\$12,844,095 @ \$16,681
3	\$15,412,900 @ \$20,017	\$12,715,643 @ \$16,514
2	\$15,389,100 @ \$19,986	\$12,696,008 @ \$16,488
1	\$14,861,000 @ \$20,385	\$12,260,325 @ \$16,818

B3 : 2房及儲物室 444'		
樓層	訂價	折實價17.5%
2	\$9,788,300 @ \$22,046	\$8,075,348 @ \$18,188
1	\$9,710,000 @ \$21,869	\$8,010,750 @ \$18,042

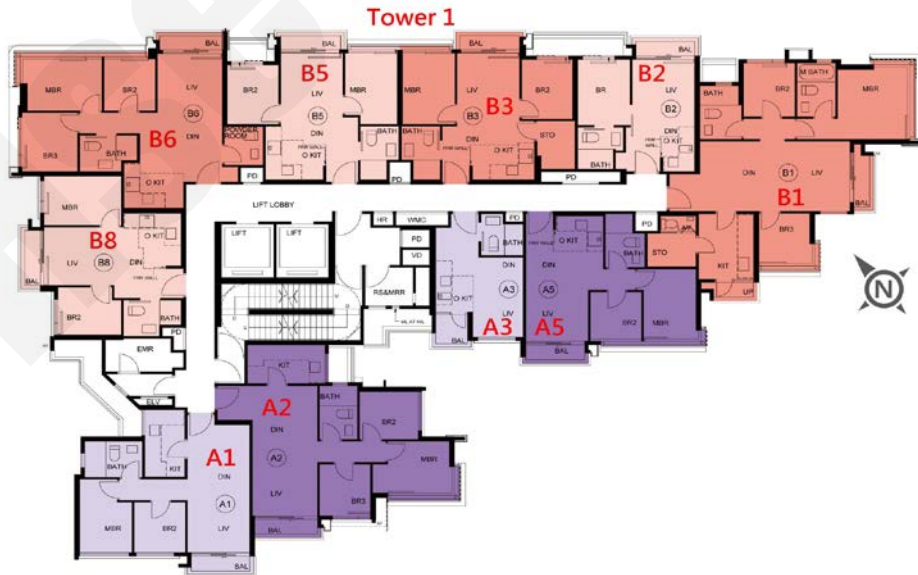

A2 : 3房連套房 589/613'		
樓層	訂價	折實價17.5%
11	\$13,285,600 @ \$21,673	\$10,960,620 @ \$17,880
10	\$13,180,100 @ \$21,501	\$10,873,583 @ \$17,738
9	\$13,101,500 @ \$21,373	\$10,808,738 @ \$17,633
8	\$13,049,300 @ \$21,288	\$10,765,673 @ \$17,562
7	\$13,023,300 @ \$21,245	\$10,744,223 @ \$17,527
6	\$12,997,300 @ \$21,203	\$10,722,773 @ \$17,492
5	\$12,971,300 @ \$21,160	\$10,701,323 @ \$17,457
3	\$12,893,500 @ \$21,033	\$10,637,138 @ \$17,353
2	\$12,790,300 @ \$20,865	\$10,551,998 @ \$17,214
1	\$13,125,300 @ \$22,284	\$10,828,373 @ \$18,384

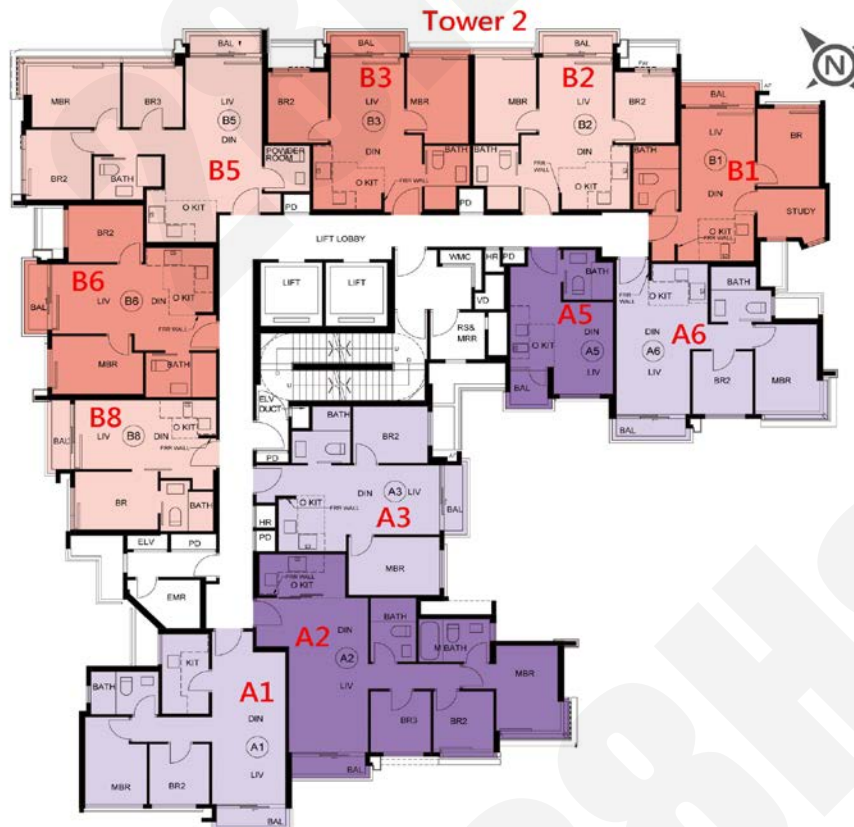

紅色為最高售價、最高平均呎價；藍色為最低售價、最低平均呎價

B5 : 3房 531'		
樓層	訂價	折實價17.5%
11	\$11,425,900 @\$21,518	\$9,426,368 @\$17,752
10	\$11,357,800 @\$21,389	\$9,370,185 @\$17,646
9	\$11,290,100 @\$21,262	\$9,314,333 @\$17,541
8	\$11,245,100 @\$21,177	\$9,277,208 @\$17,471
7	\$11,222,600 @\$21,135	\$9,258,645 @\$17,436
6	\$11,200,200 @\$21,093	\$9,240,165 @\$17,401
5	\$11,177,800 @\$21,050	\$9,221,685 @\$17,367
3	\$11,155,500 @\$21,008	\$9,203,288 @\$17,332
2	\$11,013,400 @\$20,741	\$9,086,055 @\$17,111

A2 : 3房連套房 634'		
樓層	訂價	折實價17.5%
11	\$13,746,700 @\$21,682	\$11,341,028 @\$17,888
10	\$13,637,600 @\$21,510	\$11,251,020 @\$17,746
9	\$13,556,200 @\$21,382	\$11,183,865 @\$17,640
8	\$13,502,200 @\$21,297	\$11,139,315 @\$17,570
7	\$13,475,300 @\$21,254	\$11,117,123 @\$17,535
6	\$13,448,400 @\$21,212	\$11,094,930 @\$17,500
5	\$13,421,500 @\$21,170	\$11,072,738 @\$17,465
3	\$13,340,900 @\$21,042	\$11,006,243 @\$17,360
2	\$13,234,200 @\$20,874	\$10,918,215 @\$17,221

B2 : 2房 405'		
樓層	訂價	折實價17.5%
8	\$9,075,500 @\$22,409	\$7,487,288 @\$18,487
7	\$9,057,400 @\$22,364	\$7,472,355 @\$18,450
6	\$9,039,300 @\$22,319	\$7,457,423 @\$18,413
5	\$9,021,300 @\$22,275	\$7,442,573 @\$18,377
3	\$8,777,700 @\$21,673	\$7,241,603 @\$17,881
2	\$8,470,400 @\$20,915	\$6,988,080 @\$17,255
1	\$8,339,400 @\$20,591	\$6,880,005 @\$16,988

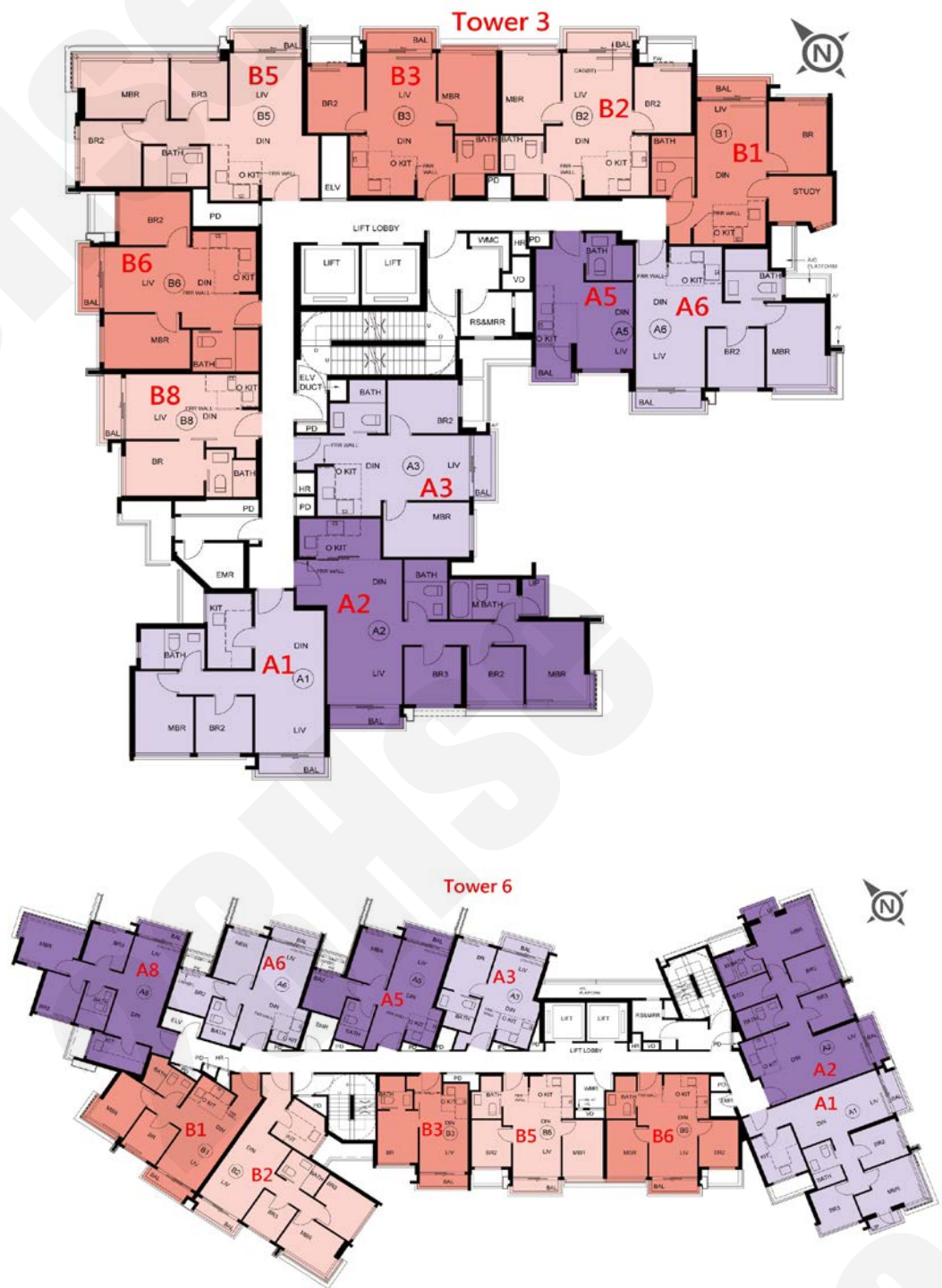

A1 : 3房 599'		
樓層	訂價	折實價17.5%
11	\$12,352,900 @\$20,623	\$10,191,143 @\$17,014
10	\$12,279,200 @\$20,499	\$10,130,340 @\$16,912
9	\$12,206,000 @\$20,377	\$10,069,950 @\$16,811
8	\$12,157,400 @\$20,296	\$10,029,855 @\$16,744
7	\$12,133,100 @\$20,256	\$10,009,808 @\$16,711
6	\$12,108,900 @\$20,215	\$9,989,843 @\$16,678
5	\$12,060,400 @\$20,134	\$9,949,830 @\$16,611
3	\$12,012,200 @\$20,054	\$9,910,065 @\$16,544
2	\$11,964,100 @\$19,973	\$9,870,383 @\$16,478

A2 : 3房連套房及儲物室 661'		
樓層	訂價	折實價17.5%
11	\$13,617,800 @\$20,602	\$11,234,685 @\$16,996
10	\$13,536,500 @\$20,479	\$11,167,613 @\$16,895
9	\$13,455,800 @\$20,357	\$11,101,035 @\$16,794
8	\$13,402,200 @\$20,276	\$11,056,815 @\$16,727
7	\$13,375,400 @\$20,235	\$11,034,705 @\$16,694
6	\$13,348,700 @\$20,195	\$11,012,678 @\$16,661
5	\$13,295,400 @\$20,114	\$10,968,705 @\$16,594
3	\$13,242,200 @\$20,034	\$10,924,815 @\$16,528
2	\$13,189,200 @\$19,953	\$10,881,090 @\$16,462

紅色為最高售價、最高平均呎價；藍色為最低售價、最低平均呎價

B5 : 3房 531'		
樓層	訂價	折實價17.5%
11	\$11,308,500 @\$21,297	\$9,329,513 @\$17,570
10	\$11,241,100 @\$21,170	\$9,273,908 @\$17,465
9	\$11,174,000 @\$21,043	\$9,218,550 @\$17,361
8	\$11,129,500 @\$20,960	\$9,181,838 @\$17,292
7	\$11,107,300 @\$20,918	\$9,163,523 @\$17,257
6	\$11,085,100 @\$20,876	\$9,145,208 @\$17,223
5	\$11,063,000 @\$20,834	\$9,126,975 @\$17,188
3	\$11,040,800 @\$20,792	\$9,108,660 @\$17,154
2	\$10,963,600 @\$20,647	\$9,044,970 @\$17,034
B3 : 2房 407'/411'		
樓層	訂價	折實價17.5%
11	\$9,151,500 @\$22,485	\$7,549,988 @\$18,550
10	\$9,096,900 @\$22,351	\$7,504,943 @\$18,440
9	\$9,042,600 @\$22,218	\$7,460,145 @\$18,330
8	\$9,006,600 @\$22,129	\$7,430,445 @\$18,257
7	\$8,988,600 @\$22,085	\$7,415,595 @\$18,220
6	\$8,970,700 @\$22,041	\$7,400,828 @\$18,184
5	\$8,952,800 @\$21,997	\$7,386,060 @\$18,148
3	\$8,711,000 @\$21,403	\$7,186,575 @\$17,657
2	\$8,464,000 @\$20,796	\$6,982,800 @\$17,157
1	\$8,324,900 @\$20,255	\$6,868,043 @\$16,711
A2 : 3房連套房 601'/640'		
樓層	訂價	折實價17.5%
11	\$13,763,000 @\$21,505	\$11,354,475 @\$17,741
10	\$13,653,700 @\$21,334	\$11,264,303 @\$17,600
9	\$13,572,300 @\$21,207	\$11,197,148 @\$17,496
8	\$13,518,200 @\$21,122	\$11,152,515 @\$17,426
7	\$13,491,200 @\$21,080	\$11,130,240 @\$17,391
6	\$13,464,300 @\$21,038	\$11,108,048 @\$17,356
5	\$13,437,400 @\$20,996	\$11,085,855 @\$17,322
3	\$13,356,800 @\$20,870	\$11,019,360 @\$17,218
2	\$13,249,900 @\$20,703	\$10,931,168 @\$17,080
1	\$13,512,500 @\$22,483	\$11,147,813 @\$18,549

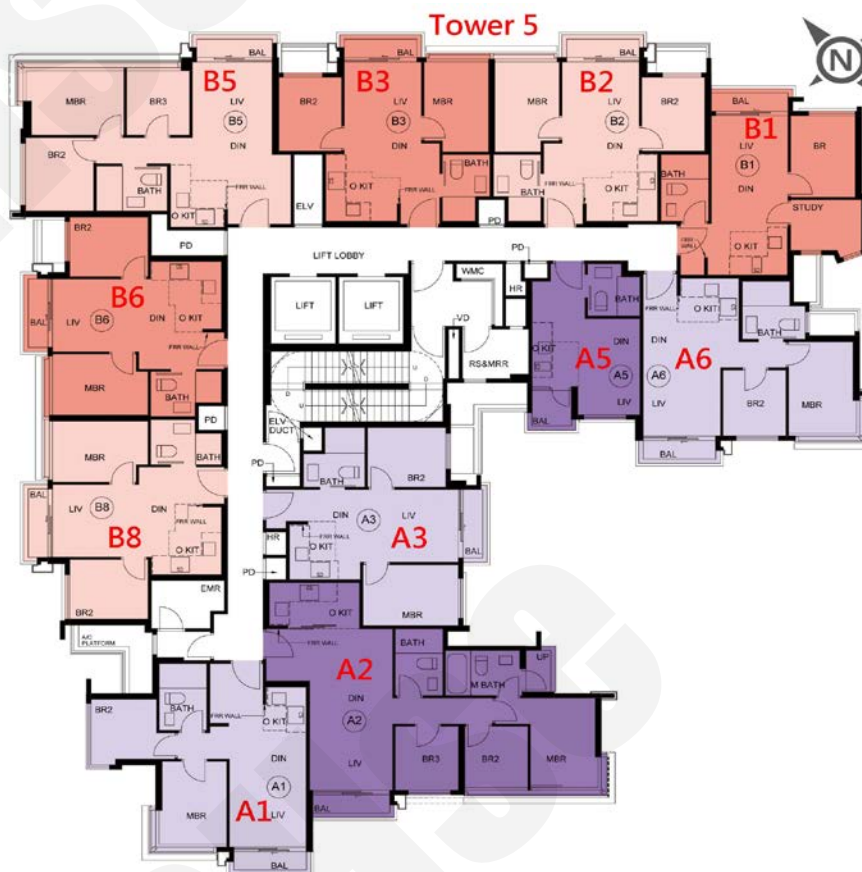

紅色為最高售價、最高平均呎價；藍色為最低售價、最低平均呎價

以上的物業資料只供參考，一切以發展商最新公布為準，如有任何資料錯漏本網頁不會承擔任何責任。