

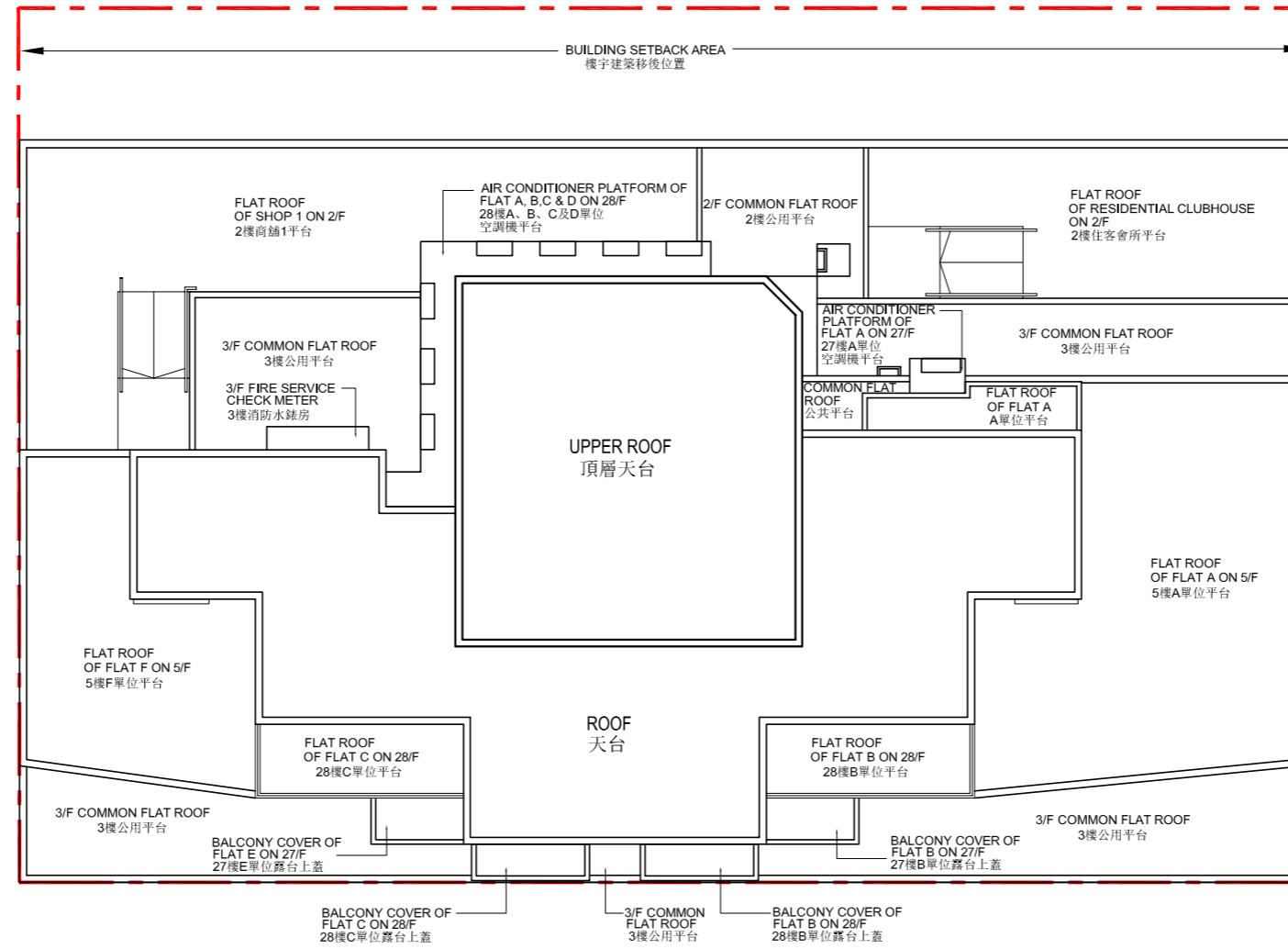

SERVICE LANE
通道巷

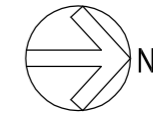

MA TAU WAI ROAD
馬頭圍道

發展項目的邊界線
BOUNDARY LINE OF THE DEVELOPMENT

Scale 比例: 0 1 2 3 4 5 10 (m/米)

The estimated date of completion of the buildings and facilities within the Development as provided by the Authorized Person for the Development is 30 June 2022
由發展項目的認可人士提供的位於發展項目內的建築物及設施的預計落成日期為 2022 年 6 月 30 日