

# Grande Monaco

以上單位訂價圖由28HSE製作

製作日期：2021年02月24日

資料來源：新盤網頁(Grande Monaco)

## 1A座

訂價	即供價 (-5%)
3房連套房及儲物室 827/829'	
27	\$28,151,000 @ \$34,040
23	\$27,692,000 @ \$33,485
20	\$27,444,000 @ \$33,185
17	\$27,118,000 @ \$32,791
15	\$26,956,000 @ \$32,595
11	\$26,258,000 @ \$31,751
9	\$26,635,000 @ \$32,207
3	\$24,340,000 @ \$29,361

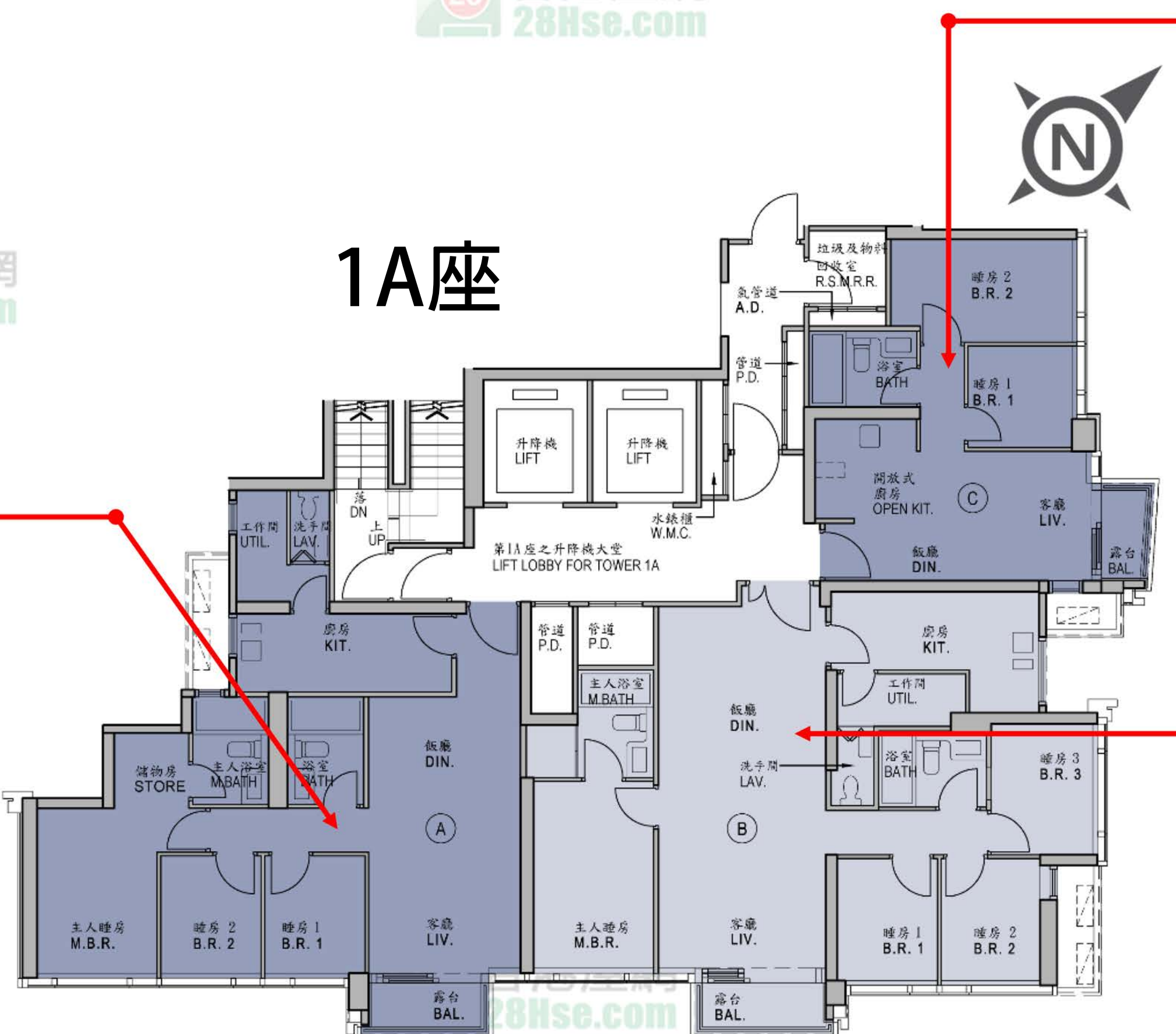

訂價		即供價 (-5%)	
2房 446/450'			
28	\$14,396,000 @ \$32,278	\$13,676,200 @ \$30,664	16
27	\$14,310,000 @ \$32,085	\$13,594,500 @ \$30,481	15
26	\$14,267,000 @ \$31,989	\$13,553,650 @ \$30,389	12
25	\$14,225,000 @ \$31,895	\$13,513,750 @ \$30,300	11
23	\$14,182,000 @ \$31,798	\$13,472,900 @ \$30,208	10
22	\$14,140,000 @ \$31,704	\$13,433,000 @ \$30,119	9
21	\$14,098,000 @ \$31,798	\$13,393,100 @ \$30,029	8
20	\$14,055,000 @ \$31,513	\$13,352,250 @ \$29,938	7
19	\$14,013,000 @ \$31,419	\$13,312,350 @ \$29,848	6
18	\$13,971,000 @ \$31,325	\$13,272,450 @ \$29,759	5
17	\$13,888,000 @ \$31,139	\$13,193,600 @ \$29,582	3

訂價		即供價 (-5%)	
4房連套房及工人套房 961'			
23	\$31,465,000 @ \$32,742	\$29,891,750 @ \$31,105	
20	\$31,184,000 @ \$32,450	\$29,624,800 @ \$30,827	
17	\$30,813,000 @ \$32,063	\$29,272,350 @ \$30,460	
15	\$30,629,000 @ \$31,872	\$29,097,550 @ \$30,278	
11	\$30,446,000 @ \$31,682	\$28,923,700 @ \$30,098	
3	\$28,571,000 @ \$29,730	\$27,142,450 @ \$28,244	

訂價		即供價 (-5%)	
1房 345/351'			
37	\$10,701,000 @ \$31,017	\$10,165,950 @ \$29,467	
36	\$10,690,000 @ \$30,986	\$10,155,500 @ \$29,436	
35	\$10,679,000 @ \$30,954	\$10,145,050 @ \$29,406	
33	\$10,674,000 @ \$30,939	\$10,140,300 @ \$29,392	
32	\$10,673,000 @ \$30,907	\$10,139,350 @ \$29,362	
31	\$10,668,000 @ \$30,881	\$10,134,600 @ \$29,337	
30	\$10,662,000 @ \$30,855	\$10,129,850 @ \$29,311	
29	\$10,657,000 @ \$30,829	\$10,125,100 @ \$29,285	
28	\$10,652,000 @ \$30,803	\$10,120,350 @ \$29,259	
27	\$10,630,000 @ \$30,777	\$10,098,500 @ \$29,233	
26	\$10,625,000 @ \$30,751	\$10,093,750 @ \$29,207	
25	\$10,614,000 @ \$30,725	\$10,083,300 @ \$29,181	
23	\$10,610,000 @ \$30,700	\$10,079,950 @ \$29,155	
22	\$10,596,000 @ \$30,674	\$10,066,200 @ \$29,129	
21	\$10,591,000 @ \$30,648	\$10,061,450 @ \$29,103	
20	\$10,551,000 @ \$30,622	\$10,023,450 @ \$29,077	
19	\$10,519,000 @ \$30,596	\$9,993,050 @ \$29,051	
18	\$10,498,000 @ \$30,570	\$9,973,100 @ \$29,025	
17	\$10,435,000 @ \$30,544	\$9,913,250 @ \$28,999	
16	\$10,404,000 @ \$30,518	\$9,883,800 @ \$28,973	
15	\$10,373,000 @ \$30,492	\$9,854,350 @ \$28,947	
12	\$10,342,000 @ \$30,466	\$9,824,900 @ \$28,921	
11	\$10,311,000 @ \$30,440	\$9,795,450 @ \$28,895	
10	\$10,285,000 @ \$30,414	\$9,770,750 @ \$28,869	
9	\$10,254,000 @ \$30,388	\$9,741,300 @ \$28,843	
8	\$10,224,000 @ \$30,362	\$9,712,800 @ \$28,817	
7	\$10,108,000 @ \$28,798	\$9,602,600 @ \$27,358	
6	\$9,848,000 @ \$28,057	\$9,355,600 @ \$26,654	
5	\$9,637,000 @ \$27,456	\$9,155,150 @ \$26,083	

訂價		即供價 (-5%)	
2房 499'			
20	\$14,808,000 @ \$29,675	\$14,067,600 @ \$28,192	
19	\$14,763,000 @ \$29,585	\$14,024,850 @ \$28,106	
18	\$14,719,000 @ \$29,497	\$13,983,050 @ \$28,022	
17	\$14,631,000 @ \$29,321	\$13,899,450 @ \$27,855	
16	\$14,588,000 @ \$29,234	\$13,858,600 @ \$27,773	
15	\$14,544,000 @ \$29,146	\$13,816,800 @ \$27,689	
12	\$14,501,000 @ \$29,060	\$13,775,950 @ \$27,607	
11	\$14,464,000 @ \$28,986	\$13,740,800 @ \$27,537	
10	\$14,421,000 @ \$28,900	\$13,699,950 @ \$27,455	
9	\$14,378,000 @ \$28,814	\$13,659,100 @ \$27,373	
6	\$14,214,000 @ \$28,485	\$13,503,300 @ \$27,061	
5	\$14,185,000 @ \$28,427	\$13,475,750 @ \$27,006	

訂價		即供價 (-5%)	
2房 495/501'			
37	\$15,253,000 @ \$30,814	\$14,490,350 @ \$29,273	
36	\$15,238,000 @ \$30,784	\$14,476,100 @ \$29,245	
35	\$15,222,000 @ \$30,752	\$14,460,900 @ \$29,214	
33	\$15,208,000 @ \$30,723	\$14,447,600 @ \$29,187	
32	\$15,208,000 @ \$30,723	\$14,447,600 @ \$29,187	
31	\$15,163,000 @ \$30,265	\$14,404,850 @ \$28,752	
30	\$15,117,000 @ \$30,174	\$14,361,150 @ \$28,665	
29	\$15,072,000 @ \$30,084	\$14,318,400 @ \$28,580	
28	\$15,027,000 @ \$29,994	\$14,275,650 @ \$28,494	
27	\$14,938,000 @ \$29,816	\$14,191,100 @ \$28,326	
26	\$14,893,000 @ \$29,727	\$14,148,350 @ \$28,240	

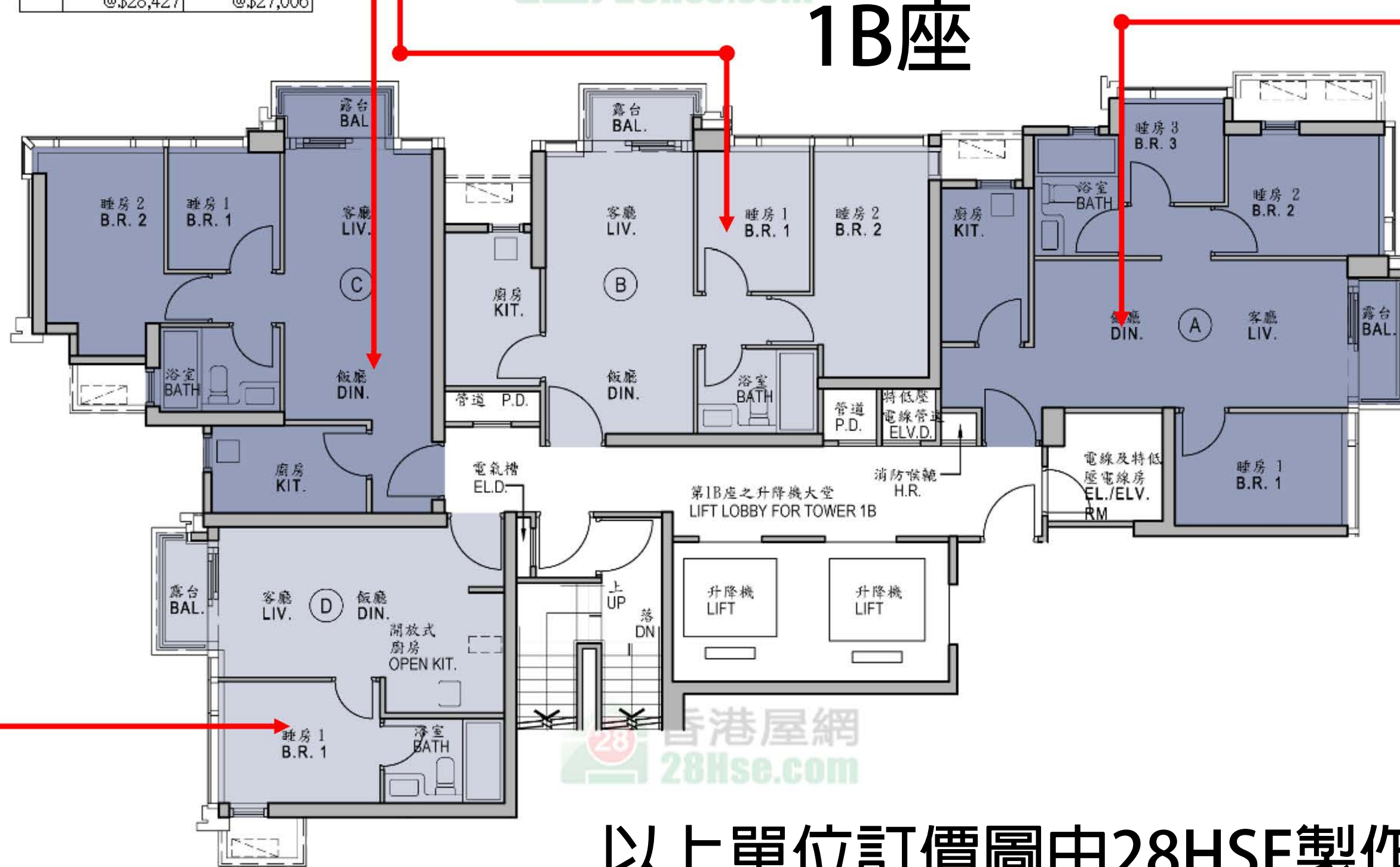

訂價		即供價 (-5%)	
3房 573'			
18	\$17,754,000 @ \$30,984	\$16,866,300 @ \$29,435	
17	\$17,648,000 @ \$30,799	\$16,765,600 @ \$29,259	
16	\$17,596,000 @ \$30,709	\$16,716,200 @ \$29,173	
15	\$17,543,000 @ \$30,616	\$16,665,850 @ \$29,085	
12	\$17,491,000 @ \$30,525	\$16,616,450 @ \$28,999	
11	\$17,438,000 @ \$30,433	\$16,566,100 @ \$28,911	
10	\$17,386,000 @ \$30,342	\$16,516,700 @ \$28,825	
9	\$17,334,000 @ \$30,251	\$16,467,300 @ \$28,739	
8	\$17,282,000 @ \$30,161	\$16,417,900 @ \$28,653	
7	\$17,179,000 @ \$29,981	\$16,320,050 @ \$28,482	
6	\$17,128,000 @ \$29,892	\$16,271,600 @ \$28,397	
5	\$17,077,000 @ \$29,803	\$16,223,150 @ \$28,313	

以上單位訂價圖由28HSE製作

製作日期：2021年02月24日

資料來源：新盤網頁(Grande Monaco)

以上的物業資料只供參考，一切以發展商最新公布為準，如有任何資料錯漏本網頁不會承擔任何責任。